



**AERIAL FCC
2016.25.**

AERIAL FCC 2016.25.



FIBRO FCC cam units series 2016.25. are a continuation of the FCC Series from a width of 700 mm and higher. This series also impresses with its excellent load bearing as well as the highest precision even after a high number of pressing.

All sliding elements of the cam unit correspond to the VDI standard. The sliding elements are shouldered to absorb thrust. The return springs are accessible from the back side of the cam unit, so that they can be dismantled from the die without removing the cam unit.

FIBRO FCC cam units series 2016.25. meet the requirements of the BAK product specifications.

Various ordering options are available for FIBRO FCC cam units series 2016.25.

- The working surface can be optionally equipped with or without shoulder
- Up to an angle of 45°, the cam units are equipped with a pre-acceleration, whereby a choice can be made between roll or plate pre-acceleration.

FIBRO cam units series 2016.25. are machined on the outer surfaces of the back side of the working surface. This makes it possible to machine the working surface of the cam unit with a simple clamping.

FIBRO FCC cam units series 2016.25. are, of course, available ex works, manufactured according to customer requirements. This meets the highest requirements of modern tool and die makers.

Design features:

- Double prismatic guide against cam driver, square positioned guiding elements against cam base.
- Sliding surfaces hardened steel / bronze with solid lubricant
- Gas springs
- Positive locking connections

FIBRO FCC cam units series 2016.25. are available in the widths from 700 to 1050 mm and in the angular variants 0° to 75 ° (gradation 5°).

Order number	Width [mm]	Performance class [kN]*	Page
2016.25.070.□□.□000.02	700	1600	179
2016.25.075.□□.□000.02	750	1600	179
2016.25.080.□□.□000.02	800	1700	189
2016.25.085.□□.□000.02	850	1700	189
2016.25.090.□□.□000.02	900	1800	199
2016.25.095.□□.□000.02	950	1800	199
2016.25.100.□□.□000.02	1000	2000	209
2016.25.105.□□.□000.02	1050	2000	209

* For exact power values, please refer to the force diagrams of the corresponding cam units

Order options:

- .1000 Working surface standard, roll pre-acceleration
- .2000 Working surface offset (shoulder on working surface), roll pre-acceleration
- .3000 Working surface standard, plate pre-acceleration
- .4000 Working surface offset (shoulder on working surface), plate pre-acceleration

Ordering example:

FIBRO cam unit FCC, aerial, width 850 mm	=	2016.25.085.□□.□000.02
Cam unit angle $\alpha = 35^\circ$	=	35.
Working surface offset (shoulder on working surface), plate pre-acceleration	=	4000.
Order number	=	2016.25.085. 35. 4000.02





AERIAL FCC **2016.25.070./075.**

Working width: 700/750 mm
Performance class: 1600 kN

AERIAL FCC
2016.25.070./075.
SIZE TABLE

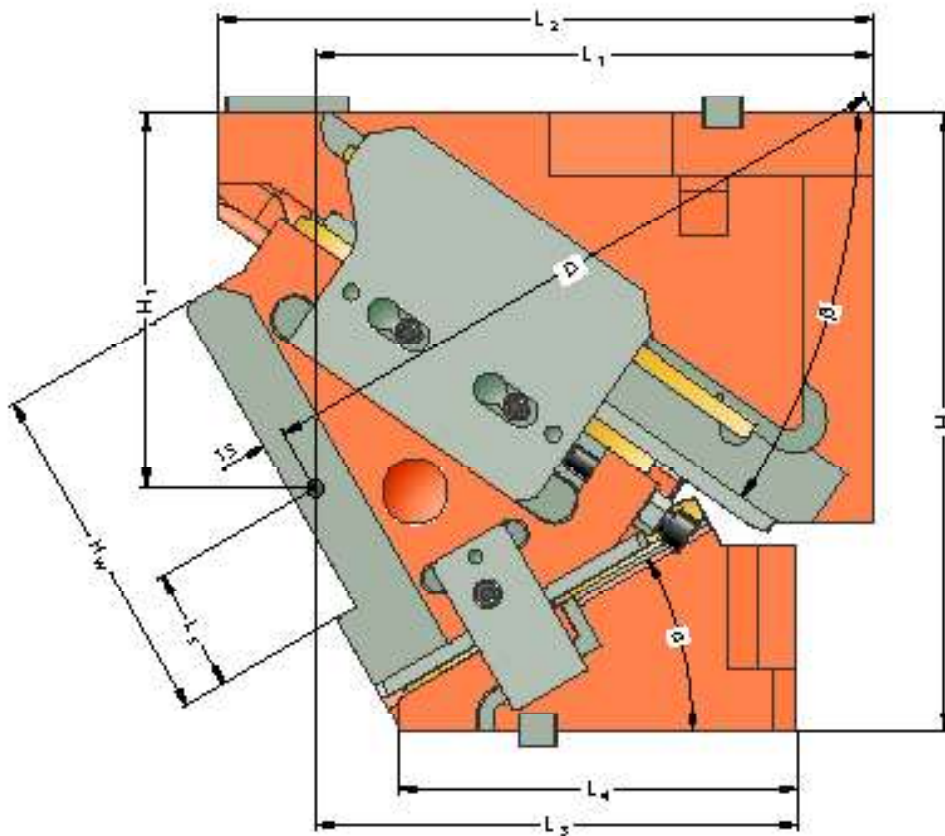
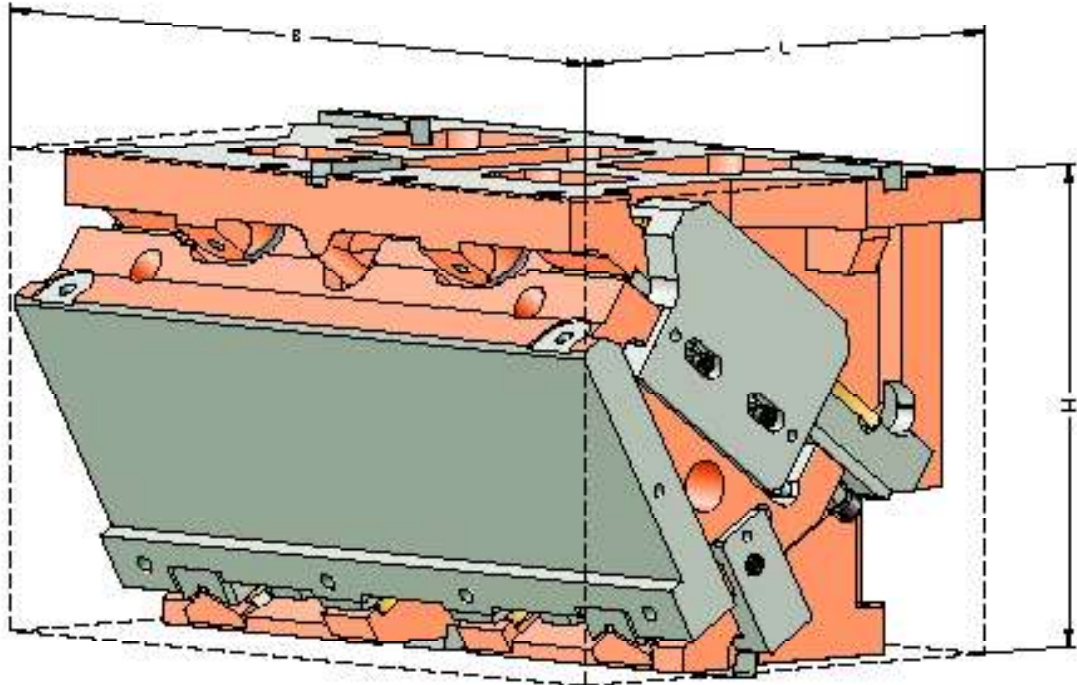

AERIAL FCC

2016.25.070./075.

SIZE TABLE

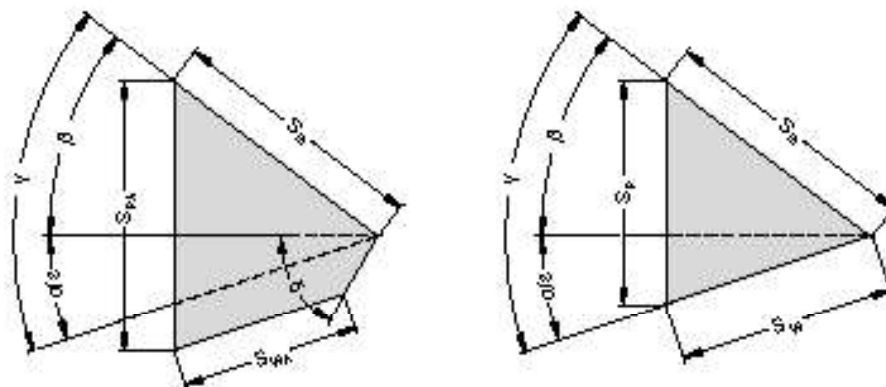

Order No.	L**	B***	H	H ₁	H _W	L ₁	L ₂	L ₃	L ₄	L ₅	D*	α	β	δ	S _W *	S _{WA} *	S _S	S _P *	S _{PA} *
	[mm]	[mm]	[mm]	[mm]	[mm]	[mm]	[mm]	[mm]	[mm]	[mm]	[mm]	[°]	[°]	[°]	[mm]	[mm]	[mm]	[mm]	[mm]
2016.25.7□0.																			
00.□000.02	395	7□0	400	208	220	365	370	280	305	80	395	0	50	45	-	45.7	100	-	95.2
05.□000.02	409.1	7□0	400	209	220	367.03	385	297.03	308	80	413.8	5	45	50	-	53.8	100	-	95.8
10.□000.02	428	7□0	400	208.61	220	374.12	385	304.12	302	80	434.7	10	45	45	-	56.6	100	-	95.5
15.□000.02	441.4	7□0	400	218.84	220	376.22	405	316.22	300	80	450	15	40	50	-	65.5	100	-	97.2
20.□000.02	449.3	7□0	400	229.69	220	373.27	410	298.27	270	80	459.3	20	40	45	-	68.8	100	-	99.8
25.□000.02	456.6	7□0	400	236.16	220	370.22	420	305.22	263	80	465.3	25	35	50	-	74.3	95	-	98.4
30.□000.02	458	7□0	400	243.22	220	362.01	425	312.01	258	80	465.1	30	35	45	-	79.5	95	-	103.2
35.□000.02	458.5	7□0	400	250.86	220	353.6	440	318.6	253	80	463.5	35	30	50	-	81.4	85	-	97.5
40.□000.02	462.9	7□0	400	259.08	220	349.93	450	324.93	247	80	464.6	40	25	55	-	93.0	85	-	104.0
45.□000.02	461.2	7□0	400	262.83	220	340.96	455	330.96	243	80	456.9	45	20	60	-	100.2	80	-	105.7
50.□000.02	483.2	7□0	400	267.09	220	356.64	480	336.64	264	80	463.9	50	10	-	107.2	-	70	94.3	-
55.□000.02	475.1	7□0	400	271.83	220	331.93	460	341.93	260	80	443.1	55	10	-	103.0	-	60	94.8	-
60.□000.02	480	7□0	400	277.01	220	316.78	470	326.78	237	80	428.3	60	10	-	108.3	-	55	103.4	-
65.□000.02	490	7□0	400	282.6	220	281.17	440	331.17	234	80	404.9	65	0	-	106.5	-	45	96.5	-
70.□000.02	505	7□0	400	288.54	220	265.05	435	335.05	232	80	391.8	70	0	-	117.0	-	40	109.9	-
75.□000.02	515	7□0	400	294.81	220	248.39	425	338.39	230	80	379.1	75	0	-	115.9	-	30	112.0	-

* Values rounded

** Values L, D measured for option with shouldered working surface

*** 7□0 = 700 or 750 mm

Mounting cam base:

Hexagon socket head cap screws DIN EN ISO 4762

8x M20 / Strength class min. 8.8

Dowel pins DIN EN ISO 8735

2x ø16

Mounting cam driver:

Hexagon socket head cap screws DIN EN ISO 4762

2x4 M16 / Strength class min. 8.8

Dowel pins DIN EN ISO 8735

2x2 ø12

AERIAL FCC
2016.25.070./075.
 EXPLODED VIEW

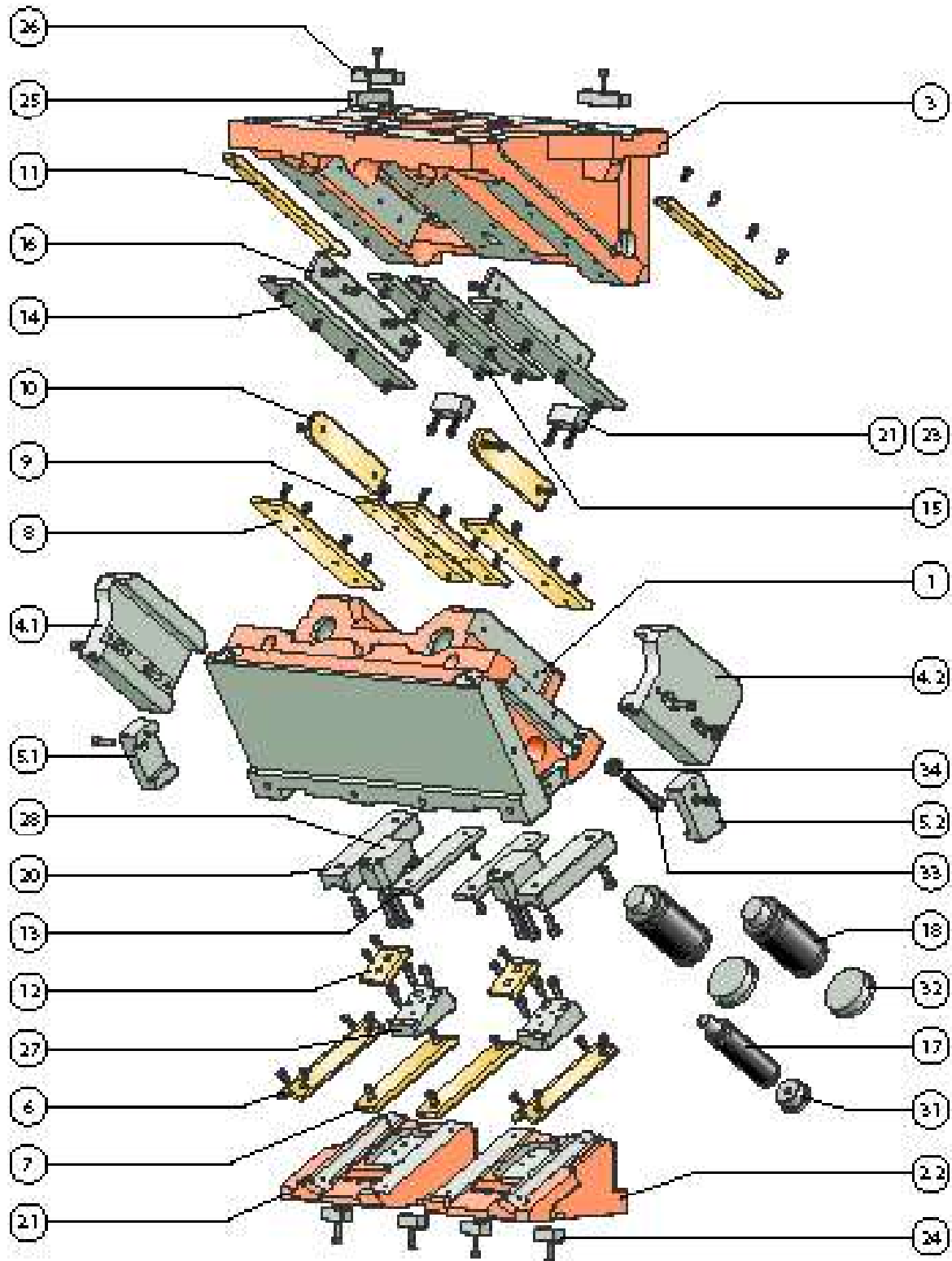

AERIAL FCC

2016.25.070./075.

PARTS LIST

Position	Piece	Designation	Material	spare part
1	1	Slider		
2.1	1	Driver, left		
2.2	1	Driver, right		
3	1	Slider base		
4.1	1	Clamp, left		x
4.2	1	Clamp, right		x
5.1	1	Positive return, left		x
5.2	1	Positive return, right		x
6	4	Sliding plate VDI	Bronze with solid lubricant	x
7	2	Sliding plate VDI	Bronze with solid lubricant	x
8	2	Sliding plate VDI	Bronze with solid lubricant	x
9	2	Sliding plate VDI	Bronze with solid lubricant	x
10	2	Sliding plate VDI	Bronze with solid lubricant	x
11	2	Sliding plate VDI	Bronze with solid lubricant	x
12**	2	Sliding plate VDI	Bronze with solid lubricant	x
13	2	Sliding plate VDI	Steel	x
14	2	Sliding plate VDI	Steel	x
15	2	Sliding plate VDI	Steel	x
16	2	Sliding plate VDI	Steel	x
17	1	Gas spring	2487.12.00750.125	x
18	2	Gas spring	2487.12.02400. □□□	x
19				x
20	2	Prismatic guide		x
21	2	Stop plate		x
22				
23	2	Damper		x
24	4	Feather key (T-nut)		x
25	1	Feather key (T-nut)		x
26	2	Feather key (T-nut)		x
27**	2	Construction piece		x
28**	2	Slide pad		x
29* (not shown)	2	Curve wedge		x
30* (not shown)	2	Roller block		x
31	1	Locking screw		x
32	2	Locking screw		x
33	2	Ball-head screw		x
34	2	Hexagon nut		x

up to and including 45° with pre-acceleration

Optionally:

* Roll pre-acceleration (.1000. /.2000.)

** Plate pre-acceleration (.3000. /.4000.)

For inquiries or when ordering spare parts (x), we require the following data:

- Cam unit order no.
- Cam unit serial number
- Item number / Designation / Spare part

AERIAL FCC

2016.25.070./075.

SYSTEM AND SURROUNDING FORCES

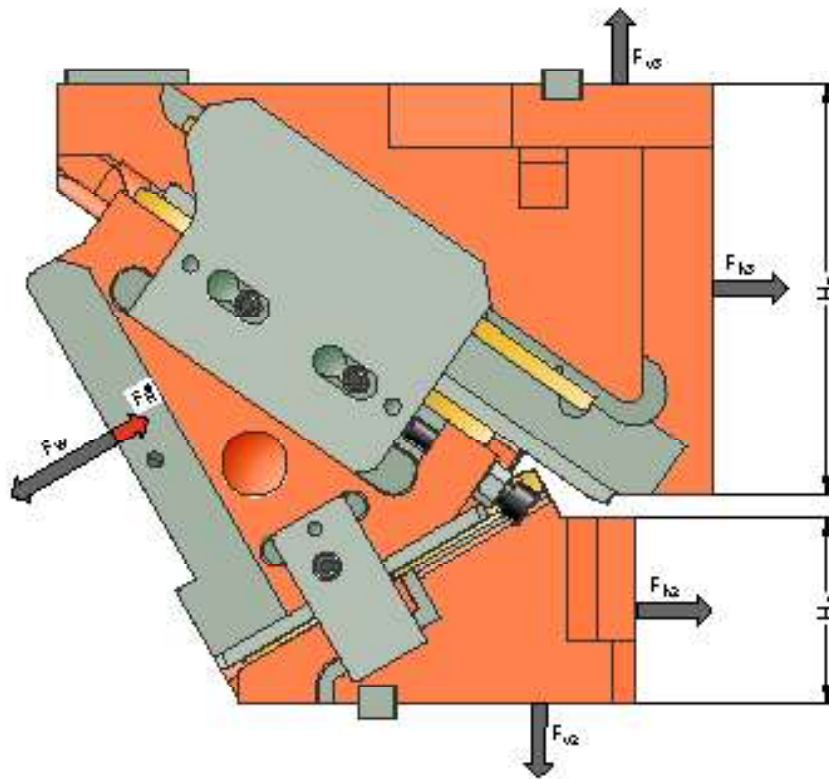

Order number	α [°]	F_W [kN]	F_{R^*} [kN]	F_{h2} [kN]	F_{v2} [kN]	F_{h3} [kN]	F_{v3} [kN]	H_2 [mm]	H_3 [mm]
2016.25.07□.00.□000.02	0	1600	101.0	0	1343	1600	1343	40	300
2016.25.07□.05.□000.02	5	1600	102.9	117	1337	1477	1477	40	275
2016.25.07□.10.□000.02	10	1600	114.5	195	1103	1381	1381	75	275
2016.25.07□.15.□000.02	15	1600	116.1	290	1082	1256	1496	80	255
2016.25.07□.20.□000.02	20	1600	131.4	316	868	1188	1415	90	245
2016.25.07□.25.□000.02	25	1600	130.3	390	837	1060	1513	110	215
2016.25.07□.30.□000.02	30	1600	151.2	373	646	1013	1446	120	210
2016.25.07□.35.□000.02	35	1600	147.2	428	611	883	1529	140	210
2016.25.07□.40.□000.02	40	1600	148.1	480	572	746	1600	150	190
2016.25.07□.45.□000.02	45	1600	146.2	528	528	604	1659	170	170
2016.25.07□.50.□000.02	50	1600	124.1	708	594	321	1819	170	120
2016.25.07□.55.□000.02	55	1600	137.6	611	428	307	1739	180	115
2016.25.07□.60.□000.02	60	1600	170.7	504	291	296	1677	180	110
2016.25.07□.65.□000.02	65	1600	135.5	676	315	0	1765	190	85
2016.25.07□.70.□000.02	70	1600	163.1	547	199	0	1703	205	85
2016.25.07□.75.□000.02	75	1600	191.8	414	111	0	1656	220	85

* Retraction force values correspond to the spring-generated retraction force at the working point point

The forces F_{h2} , F_{v2} as well as F_{h3} , F_{v3} act on the tool environment at maximum working force F_W .

AERIAL FCC

2016.25.070./075.

FORCE DIAGRAM

shouldered

		Width 700 mm						
		105	105	105	70	105	105	105
Height 225 mm	45	60	77	211	654	211	77	60
	45	72	97	336	1044	336	97	72
	45	83	117	543	1435	543	117	83
	45	94	136	653	1633	653	136	94
	45	105	156	451	1207	451	156	105

Support with feather key

		Width 700 mm						
		40	40	40	20	40	40	40
Height 225 mm	45	48	46	63	131	63	46	48
	45	58	58	101	209	101	58	58
	45	66	70	163	287	163	70	66
	45	75	82	196	327	196	82	75
	45	84	94	135	241	135	94	84

shouldered

		Width 700 mm						
		105	105	105	70	105	105	105
Height 225 mm	45	65	84	242	732	242	84	65
	45	78	108	370	1100	370	108	78
	45	89	129	566	1469	566	129	89
	45	99	143	650	1620	650	143	99
	45	108	158	458	1219	458	158	108

Support with feather key

		Width 700 mm						
		105	105	105	70	105	105	105
Height 225 mm	45	52	51	80	176	80	51	52
	45	62	65	122	264	122	65	62
	45	71	77	187	352	187	77	71
	45	79	86	215	389	215	86	79
	45	87	95	151	293	151	95	87

shouldered

		Width 700 mm						
		105	105	105	70	105	105	105
Height 225 mm	45	69	92	274	810	274	92	69
	45	83	119	404	1156	404	119	83
	45	95	141	589	1502	589	141	95
	45	103	150	648	1607	648	150	103
	45	112	160	466	1231	466	160	112

Support with feather key

		Width 700 mm						
		105	105	105	70	105	105	105
Height 225 mm	45	55	55	99	227	99	55	55
	45	67	71	145	324	145	71	67
	45	76	85	212	421	212	85	76
	45	83	90	233	450	233	90	83
	45	89	96	168	345	168	96	89

shouldered

		Width 700 mm						
		105	105	105	70	105	105	105
Height 225 mm	45	75	101	312	905	312	101	75
	45	90	132	446	1234	446	132	90
	45	104	156	624	1564	624	156	104
	45	110	160	657	1623	657	160	110
	45	117	164	482	1267	482	164	117

Support with feather key

		Width 700 mm						
		105	105	105	70	105	105	105
Height 225 mm	45	60	61	122	290	122	61	60
	45	72	79	174	395	174	79	72
	45	83	94	243	500	243	94	83
	45	88	96	256	519	256	96	88
	45	94	99	188	405	188	99	94

shouldered

		Width 700 mm						
		105	105	105	70	105	105	105
Height 225 mm	45	79	109	344	984	344	109	79
	45	96	143	481	1291	481	143	96
	45	110	169	648	1598	648	169	110
	45	115	167	655	1610	655	167	115
	45	121	166	490	1279	490	166	121

Support with feather key

		Width 700 mm						
		105	105	105	70	105	105	105
Height 225 mm	45	63	65	145	354	145	65	63
	45	77	86	202	465	202	86	77
	45	88	101	272	575	272	101	88
	45	92	100	275	580	275	100	92
	45	97	100	206	460	206	100	97

shouldered

		Width 700 mm						
		105	105	105	70	105	105	105
Height 225 mm	45	84	117	376	1064	376	117	84
	45	102	154	515	1348	515	154	102
	45	116	181	672	1632	672	181	116
	45	120	174	652	1597	652	174	120
	45	124	168	497	1292	497	168	124

Support with feather key

		Width 700 mm						
		105	105	105	70	105	105	105
Height 225 mm	45	67	70	169	426	169	70	67
	45	82	93	232	539	232	93	82
	45	93	109	302	653	302	109	93
	45	96	105	293	639	293	105	96
	45	99	101	224	517	224	101	99

AERIAL FCC

2016.25.070./075.

FORCE DIAGRAM

shouldered

		Width 700 mm						
		105	105	105	70	105	105	105
Height 225 mm	45	84	119	390	1092	390	119	84
	45	103	158	525	1341	525	158	103
	45	117	185	664	1591	664	185	117
	45	119	173	620	1511	620	173	119
	45	122	162	482	1245	482	162	122

Support with feather key

		Width 700 mm						
		105	105	105	70	105	105	105
Height 225 mm	45	67	74	187	480	187	74	67
	45	82	98	252	590	252	98	82
	45	94	114	319	700	319	114	94
	45	96	107	298	665	298	107	96
	45	98	100	231	548	231	100	98

shouldered

		Width 700 mm						
		105	105	105	70	105	105	105
Height 225 mm	45	88	125	417	1157	417	125	88
	45	107	167	553	1382	553	167	107
	45	122	195	680	1608	680	195	122
	45	123	178	612	1484	612	178	123
	45	124	162	485	1245	485	162	124

Support with feather key

		Width 700 mm						
		105	105	105	70	105	105	105
Height 225 mm	45	70	80	213	555	213	80	70
	45	86	107	282	663	282	107	86
	45	98	125	347	772	347	125	98
	45	98	114	312	712	312	114	98
	45	99	104	247	597	247	104	99

shouldered

		Width 700 mm						
		105	105	105	70	105	105	105
Height 225 mm	45	90	127	425	1170	425	127	90
	45	110	167	566	1407	566	167	110
	45	125	193	674	1595	674	193	125
	45	123	176	599	1462	599	176	123
	45	121	160	474	1227	474	160	121

Support with feather key

		Width 700 mm						
		105	105	105	70	105	105	105
Height 225 mm	45	72	84	230	609	230	84	72
	45	88	110	305	732	305	110	88
	45	100	127	364	830	364	127	100
	45	98	116	324	760	324	116	98
	45	97	106	256	638	256	106	97

shouldered

		Width 700 mm						
		105	105	105	70	105	105	105
Height 225 mm	45	93	132	441	1206	441	132	93
	45	115	170	590	1460	590	170	115
	45	130	195	681	1614	681	195	130
	45	125	178	599	1467	599	178	125
	45	120	161	472	1232	472	161	120

Support with feather key

		Width 700 mm						
		105	105	105	70	105	105	105
Height 225 mm	45	75	89	252	676	252	89	75
	45	92	116	336	818	336	116	92
	45	104	132	388	904	388	132	104
	45	100	121	341	822	341	121	100
	45	96	110	269	690	269	110	96

shouldered

		Width 700 mm						
		105	105	105	70	105	105	105
Height 225 mm	45	95	133	450	1220	450	133	95
	45	118	170	603	1486	603	170	118
	45	133	193	674	1601	674	193	133
	45	125	176	586	1444	586	176	125
	45	116	159	462	1213	462	159	116

Support with feather key

		Width 700 mm						
		105	105	105	70	105	105	105
Height 225 mm	45	76	93	270	732	270	93	76
	45	94	119	362	892	362	119	94
	45	107	135	404	961	404	135	107
	45	100	123	352	866	352	123	100
	45	93	112	277	728	277	112	93

shouldered

		Width 700 mm						
		105	105	105	70	105	105	105
Height 225 mm	45	97	135	458	1234	458	135	97
	45	121	170	617	1512	617	170	121
	45	136	191	668	1589	668	191	136
	45	125	174	574	1421	574	174	125
	45	113	158	451	1195	451	158	113

Support with feather key

		Width 700 mm						
		105	105	105	70	105	105	105
Height 225 mm	45	78	98	288	790	288	98	78
	45	97	122	388	967	388	122	97
	45	109	138	421	1017	421	138	109
	45	100	126	362	910	362	126	100
	45	90	113	284	764	284	113	90

AERIAL FCC

2016.25.070./075.

FORCE DIAGRAM

shouldered

		Width 700 mm							
		105	105	105	70	105	105	105	
Height 225 mm	60°	45	101	140	475	1271	475	140	101
	45	126	173	642	1566	642	173	126	
	45	142	193	674	1606	674	193	142	
	45	127	176	572	1425	572	176	127	
	45	112	159	449	1198	449	159	112	

Support with feather key

		Width 700 mm							
		105	105	105	70	105	105	105	
Height 225 mm	60°	45	81	104	313	864	313	104	81
	45	101	128	424	1065	424	128	101	
	45	113	143	445	1092	445	143	113	
	45	101	130	378	969	378	130	101	
	45	89	117	296	815	296	117	89	

shouldered

		Width 700 mm							
		105	105	105	70	105	105	105	
Height 225 mm	65°	45	105	145	492	1309	492	145	105
	45	132	176	667	1622	667	176	132	
	45	147	195	679	1623	679	195	147	
	45	129	177	570	1427	570	177	129	
	45	110	160	446	1201	446	160	110	

Support with feather key

		Width 700 mm							
		105	105	105	70	105	105	105	
Height 225 mm	65°	45	84	110	339	943	339	110	84
	45	105	134	461	1168	461	134	105	
	45	118	148	469	1168	469	148	118	
	45	103	135	393	1028	393	135	103	
	45	88	121	308	865	308	121	88	

shouldered

		Width 700 mm							
		105	105	105	70	105	105	105	
Height 225 mm	70°	45	104	143	487	1287	487	143	104
	45	131	171	663	1604	663	171	131	
	45	146	188	654	1566	654	188	146	
	45	125	171	542	1365	542	171	125	
	45	104	154	423	1150	423	154	104	

Support with feather key

		Width 700 mm							
		105	105	105	70	105	105	105	
Height 225 mm	70°	45	83	111	350	978	350	111	83
	45	105	133	477	1219	477	133	105	
	45	117	146	471	1190	471	146	117	
	45	100	133	390	1038	390	133	100	
	45	83	120	304	874	304	120	83	

shouldered

		Width 700 mm							
		105	105	105	70	105	105	105	
Height 225 mm	75°	45	105	143	490	1289	490	143	105
	45	133	169	670	1615	670	169	133	
	45	148	184	642	1539	642	184	148	
	45	124	167	525	1330	525	167	124	
	45	99	150	408	1120	408	150	99	

Support with feather key

		Width 700 mm							
		105	105	105	70	105	105	105	
Height 225 mm	75°	45	84	115	368	1031	368	115	84
	45	106	135	502	1292	502	135	106	
	45	118	147	481	1231	481	147	118	
	45	99	134	394	1064	394	134	99	
	45	80	120	306	896	306	120	80	



AERIAL FCC
2016.25.080./085.

Working width: 800/850 mm
Performance class: 1700 kN

AERIAL FCC
2016.25.080./085.
SIZE TABLE

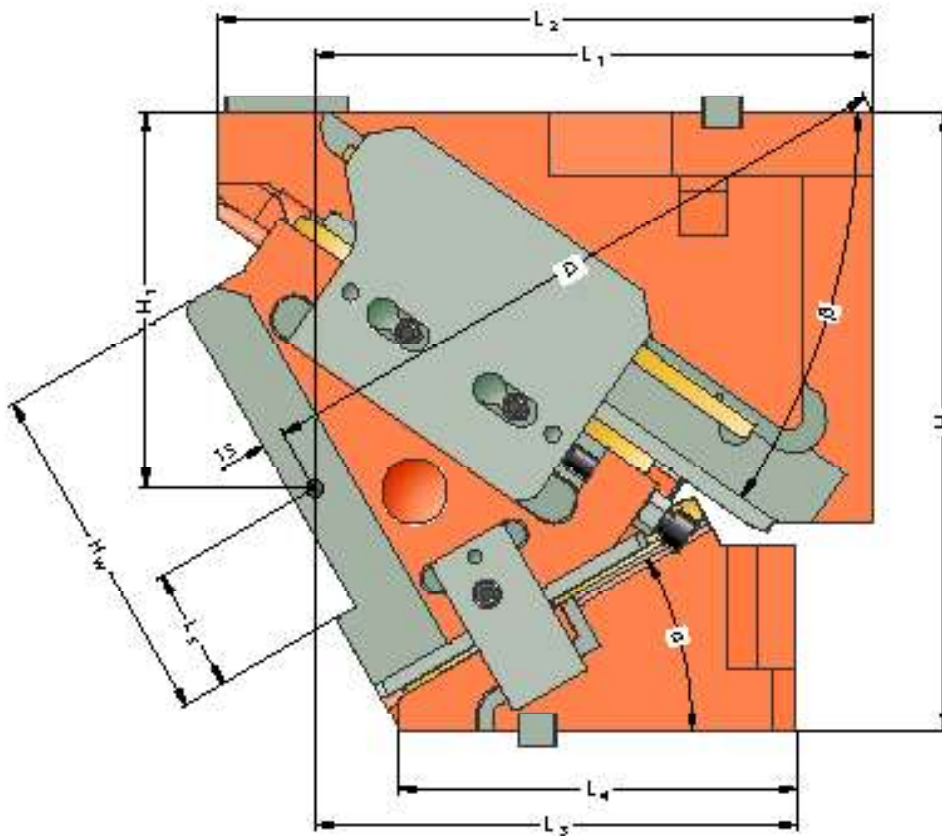
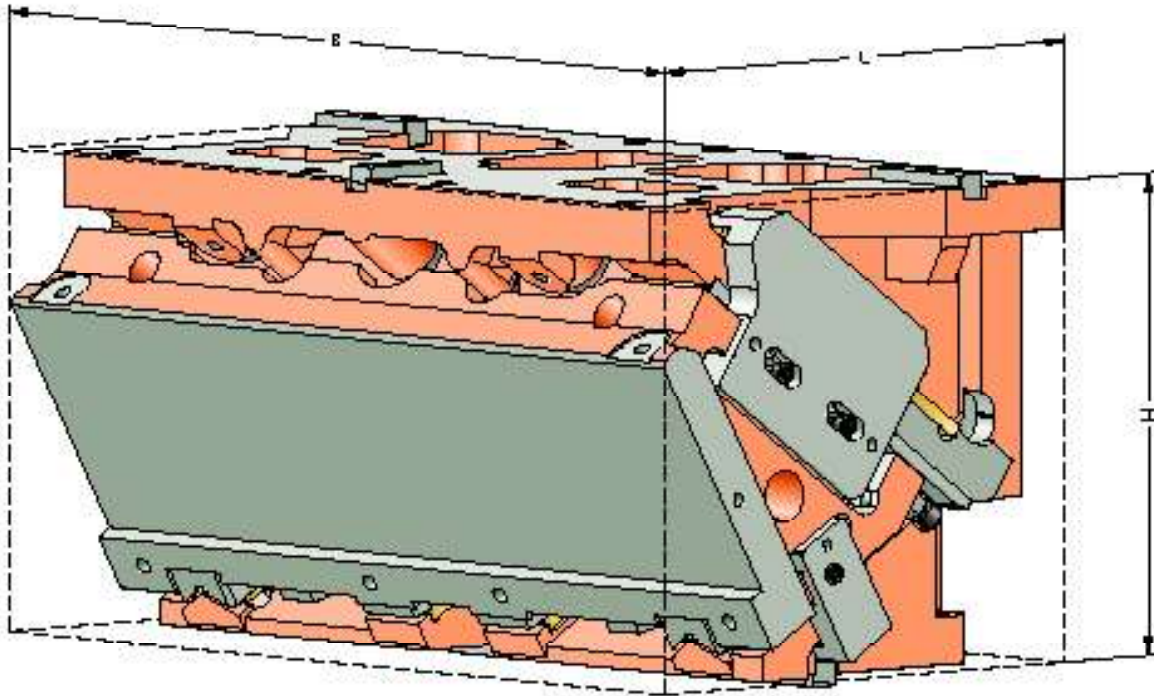

AERIAL FCC

2016.25.080./085.

SIZE TABLE

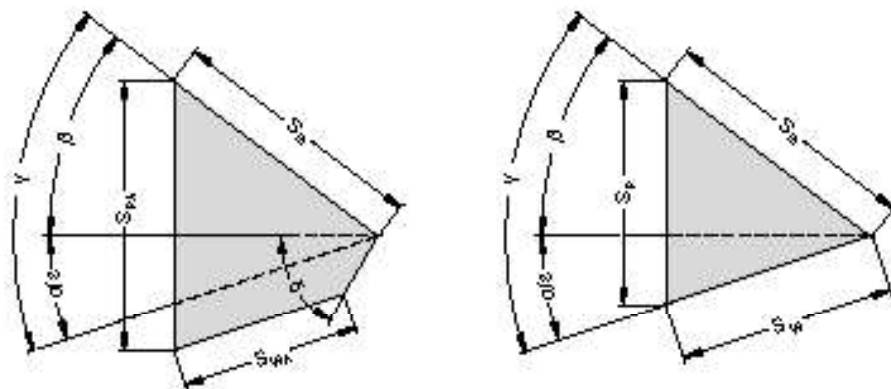

Order No.	L**	B***	H	H ₁	H _W	L ₁	L ₂	L ₃	L ₄	L ₅	D**	α	β	δ	S _W *	S _{WA} *	S _S	S _P *	S _{PA} *
2016.25.8□0.	[mm]	[mm]	[mm]	[mm]	[mm]	[mm]	[mm]	[mm]	[mm]	[mm]	[mm]	[°]	[°]	[°]	[mm]	[mm]	[mm]	[mm]	[mm]
00.□000.02	395	8□0	400	208	220	365	370	280	305	80	395	0	50	45	-	45.7	100	-	95.2
05.□000.02	409.1	8□0	400	209	220	367.03	385	297.03	308	80	413.84	5	45	50	-	53.8	100	-	95.8
10.□000.02	428	8□0	400	208.61	220	374.12	385	304.12	302	80	434.66	10	45	45	-	56.6	100	-	95.5
15.□000.02	441.4	8□0	400	218.84	220	376.22	405	316.22	300	80	450.04	15	40	50	-	65.5	100	-	97.2
20.□000.02	449.3	8□0	400	229.69	220	373.27	410	298.27	270	80	459.32	20	40	45	-	68.8	100	-	99.8
25.□000.02	456.6	8□0	400	236.16	220	370.22	420	305.22	263	80	465.33	25	35	50	-	74.3	95	-	98.4
30.□000.02	458	8□0	400	243.22	220	362.01	425	312.01	258	80	465.12	30	35	45	-	79.5	95	-	103.2
35.□000.02	458.5	8□0	400	250.86	220	353.6	440	318.6	253	80	463.54	35	30	50	-	81.4	85	-	97.5
40.□000.02	462.9	8□0	400	259.08	220	349.93	450	324.93	247	80	464.59	40	25	55	-	93.0	85	-	104.0
45.□000.02	461.2	8□0	400	262.83	220	340.96	455	330.96	243	80	456.94	45	20	60	-	100.2	80	-	105.7
50.□000.02	483.2	8□0	400	267.09	220	356.64	480	336.64	264	80	463.85	50	10	-	107.2	-	70	94.3	-
55.□000.02	475.1	8□0	400	271.83	220	331.93	460	341.93	260	80	443.05	55	10	-	103.0	-	60	94.8	-
60.□000.02	480	8□0	400	277.01	220	316.78	470	326.78	237	80	428.29	60	10	-	108.3	-	55	103.4	-
65.□000.02	490	8□0	400	282.6	220	281.17	440	331.17	234	80	404.94	65	0	-	106.5	-	45	96.5	-
70.□000.02	505	8□0	400	288.54	220	265.05	435	335.05	232	80	391.79	70	0	-	117.0	-	40	109.9	-
75.□000.02	515	8□0	400	294.81	220	248.39	425	338.39	230	80	379.05	75	0	-	115.9	-	30	112.0	-

* Values rounded

** Values L, D measured for option with shouldered working surface

*** 8□0 = 800 or 850 mm

Mounting cam base:

Hexagon socket head cap screws DIN EN ISO 4762

8x M20 / Strength class min. 8.8

Dowel pins DIN EN ISO 8735

2x ø16

Mounting cam driver:

Hexagon socket head cap screws DIN EN ISO 4762

2x4 M16 / Strength class min. 8.8

Dowel pins DIN EN ISO 8735

2x2 ø12

AERIAL FCC
2016.25.080./085.
 EXPLODED VIEW

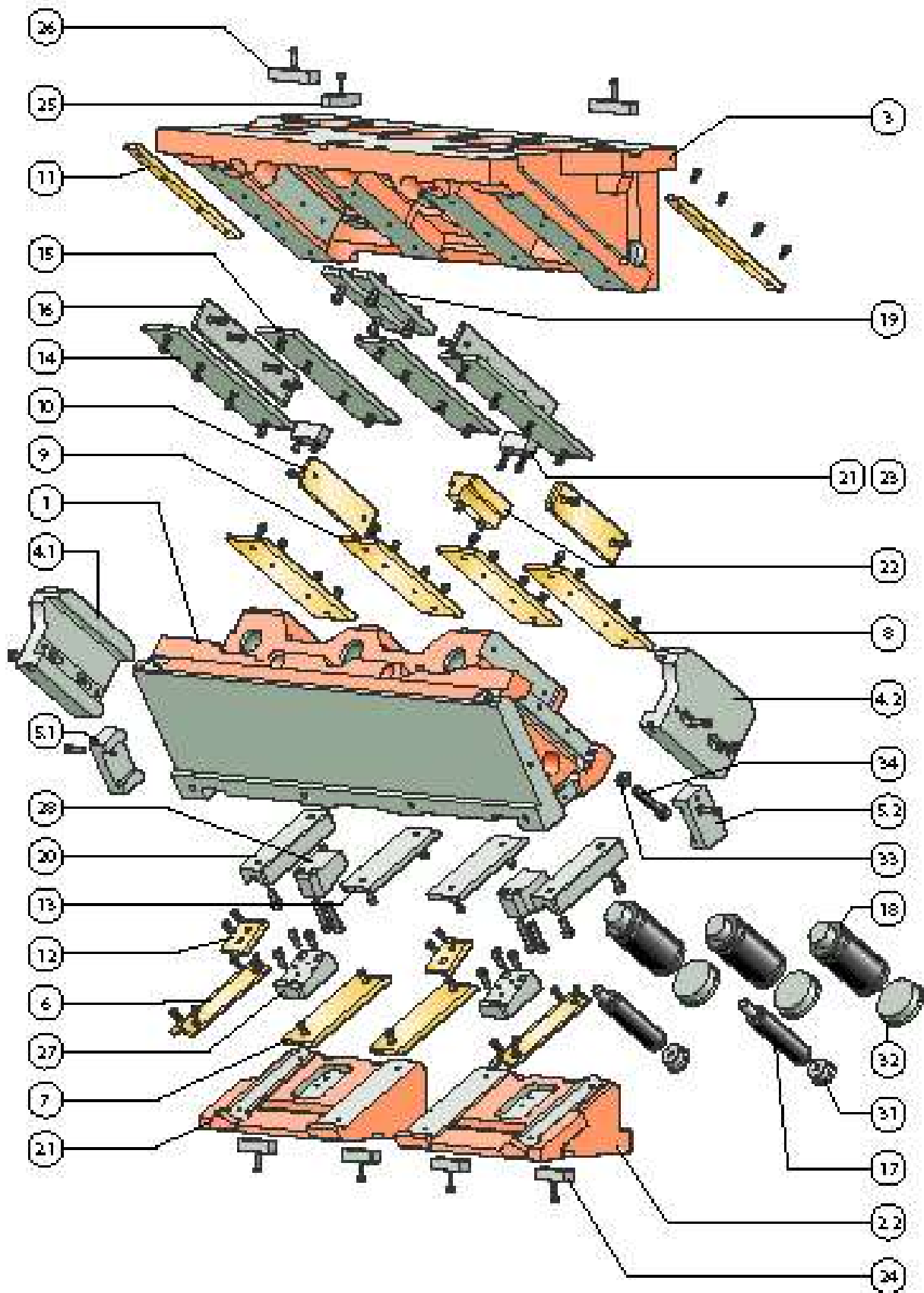

AERIAL FCC

2016.25.080./085.

PARTS LIST

Position	Piece	Designation	Material	spare part
1	1	Slider		
2.1	1	Driver, left		
2.2	1	Driver, right		
3	1	Slider cam base		
4.1	1	Clamp, left		x
4.2	1	Clamp, right		x
5.1	1	Positive return, left		x
5.2	1	Positive return, right		x
6	4	Sliding plate VDI	Bronze with solid lubricant	x
7	2	Sliding plate VDI	Bronze with solid lubricant	x
8	2	Sliding plate VDI	Bronze with solid lubricant	x
9	2	Sliding plate VDI	Bronze with solid lubricant	x
10	2	Sliding plate VDI	Bronze with solid lubricant	x
11	2	Sliding plate VDI	Bronze with solid lubricant	x
12**	2	Sliding plate VDI	Bronze with solid lubricant	x
13	2	Sliding plate VDI	Steel	x
14	2	Sliding plate VDI	Steel	x
15	2	Sliding plate VDI	Steel	x
16	2	Sliding plate VDI	Steel	x
17	2	Gas spring	2487.12.00500.125	x
18	3	Gas spring	2487.12.02400.□□□	x
19	2	Cover strip		x
20	2	Prismatic guide		x
21	2	Stop plate		x
22	1	Centre guide		x
23	2	Damper		x
24	4	Feather key (T-nut)		x
25	1	Feather key (T-nut)		x
26	2	Feather key (T-nut)		x
27**	2	Construction piece		x
28**	2	Slide pad		x
29* (not shown)	2	Curve wedge		x
30* (not shown)	2	Roller block		x
31	2	Locking screw		x
32	3	Locking screw		x
33	2	Ball-head screw		x
34	2	Hexagon nut		x

up to and including 45° with pre-acceleration

Optionally:

* Roll pre-acceleration (.1000. /.2000.)

** Plate pre-acceleration (.3000. /.4000.)

For inquiries or when ordering spare parts (x), we require the following data:

- Cam unit order no.
- Cam unit serial number
- Item number / Designation / Spare part

AERIAL FCC

2016.25.080./085.

SYSTEM AND SURROUNDING FORCES

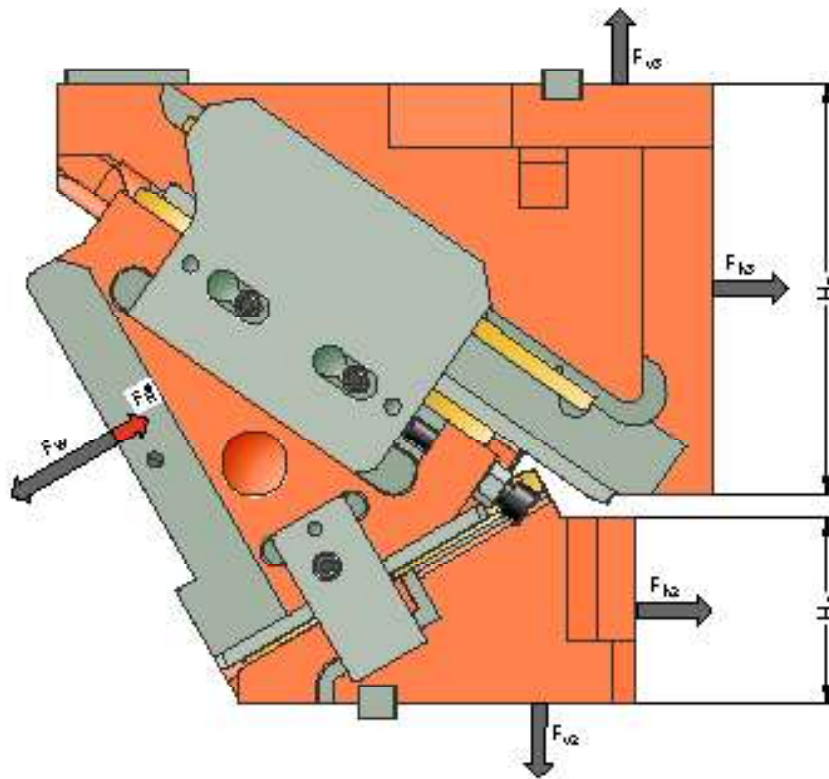

Order number	α [°]	F_W [kN]	F_{R^*} [kN]	F_{h2} [kN]	F_{v2} [kN]	F_{h3} [kN]	F_{v3} [kN]	H_2 [mm]	H_3 [mm]
2016.25.08□.02.□000.02	0	1700	149.3	0	1426	1700	1426	40	300
2016.25.08□.05.□000.02	5	1700	152.3	124	1421	1569	1569	40	275
2016.25.08□.10.□000.02	10	1700	169.6	207	1172	1467	1467	75	275
2016.25.08□.15.□000.02	15	1700	172.3	308	1150	1334	1590	80	255
2016.25.08□.20.□000.02	20	1700	195.1	407	1119	1190	1700	90	245
2016.25.08□.25.□000.02	25	1700	193.9	415	890	1126	1608	110	215
2016.25.08□.30.□000.02	30	1700	225.1	396	687	1076	1537	120	210
2016.25.08□.35.□000.02	35	1700	219.4	455	649	938	1624	140	210
2016.25.08□.40.□000.02	40	1700	221.1	510	607	793	1700	150	190
2016.25.08□.45.□000.02	45	1700	218.6	561	561	642	1763	170	170
2016.25.08□.50.□000.02	50	1700	186.1	752	631	341	1933	170	120
2016.25.08□.55.□000.02	55	1700	206.6	649	455	326	1847	180	115
2016.25.08□.60.□000.02	60	1700	256.5	536	309	314	1782	180	110
2016.25.08□.65.□000.02	65	1700	204.3	718	335	0	1876	190	85
2016.25.08□.70.□000.02	70	1700	246.0	581	212	0	1809	205	85
2016.25.08□.75.□000.02	75	1700	289.9	440	118	0	1760	220	85

* Retraction force values correspond to the spring-generated retraction force at the working point point

The forces F_{h2} , F_{v2} as well as F_{h3} , F_{v3} act on the tool environment at maximum working force F_W .

AERIAL FCC

2016.25.080./085.

FORCE DIAGRAM

shouldered

		Width 800 mm						
		120	120	120	80	120	120	120
Height 225 mm	45	76	113	335	869	335	113	76
	45	94	145	491	1310	491	145	94
	45	108	169	689	1680	689	169	108
	45	114	169	703	1705	703	169	114
	45	120	169	504	1306	504	169	120

Support with feather key

		Width 800 mm						
		120	120	120	80	120	120	120
Height 225 mm	45	61	68	100	174	100	68	61
	45	75	87	147	262	147	87	75
	45	87	101	207	336	207	101	87
	45	91	101	211	341	211	101	91
	45	96	102	151	261	151	102	96

0°

		Width 800 mm						
		120	120	120	80	120	120	120
Height 225 mm	45	79	118	354	926	354	118	79
	45	97	152	512	1345	512	152	97
	45	112	178	705	1703	705	178	112
	45	117	175	705	1704	705	175	117
	45	123	172	514	1322	514	172	123

0°

		Width 800 mm						
		120	120	120	80	120	120	120
Height 225 mm	45	63	71	117	222	117	71	63
	45	78	91	169	323	169	91	78
	45	90	107	233	409	233	107	90
	45	94	105	233	409	233	105	94
	45	98	103	170	317	170	103	98

5°

		Width 800 mm						
		120	120	120	80	120	120	120
Height 225 mm	45	81	123	374	984	374	123	81
	45	100	160	533	1380	533	160	100
	45	116	186	721	1725	721	186	116
	45	121	180	708	1703	708	180	121
	45	126	174	524	1339	524	174	126

5°

		Width 800 mm						
		120	120	120	80	120	120	120
Height 225 mm	45	65	74	135	275	135	74	65
	45	80	96	192	386	192	96	80
	45	93	112	259	483	259	112	93
	45	97	108	255	477	255	108	97
	45	101	104	189	375	189	104	101

10°

		Width 800 mm						
		120	120	120	80	120	120	120
Height 225 mm	45	82	126	387	1022	387	126	82
	45	102	165	545	1389	545	165	102
	45	117	191	723	1715	723	191	117
	45	122	182	698	1671	698	182	122
	45	126	173	524	1331	524	173	126

10°

		Width 800 mm						
		120	120	120	80	120	120	120
Height 225 mm	45	66	75	151	327	151	75	66
	45	82	99	212	444	212	99	82
	45	94	115	282	549	282	115	94
	45	97	109	272	535	272	109	97
	45	101	104	204	426	204	104	101

15°

		Width 800 mm						
		120	120	120	80	120	120	120
Height 225 mm	45	84	130	402	1069	402	130	84
	45	104	170	561	1410	561	170	104
	45	120	198	732	1721	732	198	120
	45	124	186	694	1655	694	186	124
	45	128	174	529	1334	529	174	128

15°

		Width 800 mm						
		120	120	120	80	120	120	120
Height 225 mm	45	67	78	169	385	169	78	67
	45	83	102	235	508	235	102	83
	45	96	119	307	620	307	119	96
	45	99	112	291	596	291	112	99
	45	102	104	222	480	222	104	102

20°

		Width 800 mm						
		120	120	120	80	120	120	120
Height 225 mm	45	87	136	425	1135	425	136	87
	45	108	179	587	1457	587	179	108
	45	125	208	754	1759	754	208	125
	45	128	193	703	1670	703	193	128
	45	132	178	543	1363	543	178	132

20°

		Width 800 mm						
		120	120	120	80	120	120	120
Height 225 mm	45	70	81	191	454	191	81	70
	45	87	108	264	583	264	108	87
	45	100	125	339	704	339	125	100
	45	103	116	316	668	316	116	103
	45	106	107	244	545	244	107	106

AERIAL FCC

2016.25.080./085.

FORCE DIAGRAM

shouldered

		Width 800 mm						
		120	120	120	80	120	120	120
Height 225 mm	45	90	141	445	1191	445	141	90
	45	112	187	608	1491	608	187	112
	45	128	217	769	1781	769	217	128
	45	132	198	705	1669	705	198	132
	45	135	180	553	1379	553	180	135

Support with feather key

		Width 800 mm						
		120	120	120	80	120	120	120
Height 225 mm	45	72	87	213	524	213	87	72
	45	89	116	292	656	292	116	89
	45	103	134	369	784	369	134	103
	45	105	123	339	734	339	123	105
	45	108	112	265	607	265	112	108

35°

		Width 800 mm						
		120	120	120	80	120	120	120
Height 225 mm	45	87	138	438	1178	438	138	87
	45	108	183	594	1440	594	183	108
	45	125	213	741	1702	741	213	125
	45	128	192	669	1575	669	192	128
	45	130	172	531	1318	531	172	130

35°

		Width 800 mm						
		120	120	120	80	120	120	120
Height 225 mm	45	70	88	224	566	224	88	70
	45	87	117	303	691	303	117	87
	45	100	136	378	817	378	136	100
	45	102	123	341	756	341	123	102
	45	104	110	271	633	271	110	104

40°

		Width 800 mm						
		120	120	120	80	120	120	120
Height 225 mm	45	90	139	451	1202	451	139	90
	45	112	184	608	1467	608	184	112
	45	129	212	738	1695	738	212	129
	45	128	191	658	1556	658	191	128
	45	127	170	522	1303	522	170	127

40°

		Width 800 mm						
		120	120	120	80	120	120	120
Height 225 mm	45	72	92	244	625	244	92	72
	45	90	121	328	763	328	121	90
	45	103	140	399	882	399	140	103
	45	102	126	356	809	356	126	102
	45	102	112	282	677	282	112	102

45°

		Width 800 mm						
		120	120	120	80	120	120	120
Height 225 mm	45	93	142	469	1238	469	142	93
	45	117	186	629	1509	629	186	117
	45	134	214	742	1705	742	214	134
	45	130	191	655	1552	655	191	130
	45	125	169	518	1300	518	169	125

45°

		Width 800 mm						
		120	120	120	80	120	120	120
Height 225 mm	45	74	96	267	693	267	96	74
	45	94	127	358	845	358	127	94
	45	107	145	423	955	423	145	107
	45	104	130	373	869	373	130	104
	45	100	115	295	728	295	115	100

50°

		Width 800 mm						
		120	120	120	80	120	120	120
Height 225 mm	45	96	144	486	1274	486	144	96
	45	122	188	649	1551	649	188	122
	45	139	215	746	1714	746	215	139
	45	131	191	650	1547	650	191	131
	45	124	167	513	1298	513	167	124

50°

		Width 800 mm						
		120	120	120	80	120	120	120
Height 225 mm	45	77	101	292	765	292	101	77
	45	97	132	390	931	390	132	97
	45	111	151	448	1028	448	151	111
	45	105	134	390	928	390	134	105
	45	99	117	308	779	308	117	99

55°

		Width 800 mm						
		120	120	120	80	120	120	120
Height 225 mm	45	99	147	504	1311	504	147	99
	45	127	191	670	1594	670	191	127
	45	144	217	750	1723	750	217	144
	45	133	192	646	1542	646	192	133
	45	122	166	509	1295	509	166	122

55°

		Width 800 mm						
		120	120	120	80	120	120	120
Height 225 mm	45	80	106	318	839	318	106	80
	45	101	137	422	1020	422	137	101
	45	116	156	473	1103	473	156	116
	45	106	138	407	987	407	138	106
	45	97	120	321	829	321	120	97

AERIAL FCC

2016.25.080./085.

FORCE DIAGRAM

shouldered

		Width 800 mm						
		120	120	120	80	120	120	120
Height 225 mm	45	102	148	517	1335	517	148	102
	45	131	191	685	1622	685	191	131
	45	148	217	747	1716	747	217	148
	45	133	190	636	1523	636	190	133
	45	118	163	499	1279	499	163	118

Support with feather key

		Width 800 mm						
		120	120	120	80	120	120	120
Height 225 mm	45	81	110	341	908	341	110	81
	45	104	141	452	1103	452	141	104
	45	119	160	493	1167	493	160	119
	45	107	141	420	1035	420	141	107
	45	95	121	330	870	330	121	95

65°

		Width 800 mm						
		120	120	120	80	120	120	120
Height 225 mm	45	103	148	526	1347	526	148	103
	45	133	190	693	1634	693	190	133
	45	151	214	737	1692	737	214	151
	45	133	187	619	1488	619	187	133
	45	114	159	485	1252	485	159	114

65°

		Width 800 mm						
		120	120	120	80	120	120	120
Height 225 mm	45	83	113	363	970	363	113	83
	45	107	144	478	1176	478	144	107
	45	121	163	508	1218	508	163	121
	45	106	142	427	1072	427	142	106
	45	91	121	335	901	335	121	91

70°

		Width 800 mm						
		120	120	120	80	120	120	120
Height 225 mm	45	106	149	539	1371	539	149	106
	45	137	190	708	1661	708	190	137
	45	155	214	734	1685	734	214	155
	45	133	185	609	1469	609	185	133
	45	111	156	476	1237	476	156	111

70°

		Width 800 mm						
		120	120	120	80	120	120	120
Height 225 mm	45	84	117	388	1042	388	117	84
	45	110	148	510	1263	510	148	110
	45	124	167	528	1280	528	167	124
	45	106	144	438	1116	438	144	106
	45	89	122	342	940	342	122	89

75°

		Width 800 mm						
		120	120	120	80	120	120	120
Height 225 mm	45	109	152	557	1409	557	152	109
	45	142	193	730	1705	730	193	142
	45	160	215	737	1693	737	215	160
	45	135	185	604	1463	604	185	135
	45	109	155	471	1233	471	155	109

75°

		Width 800 mm						
		120	120	120	80	120	120	120
Height 225 mm	45	87	122	418	1127	418	122	87
	45	114	154	547	1364	547	154	114
	45	128	172	553	1355	553	172	128
	45	108	148	453	1171	453	148	108
	45	87	124	353	987	353	124	87



AERIAL FCC **2016.25.090./095.**

Working width: 900/950 mm
Performance class: 1800 kN

AERIAL FCC
2016.25.090./095.
SIZE TABLE

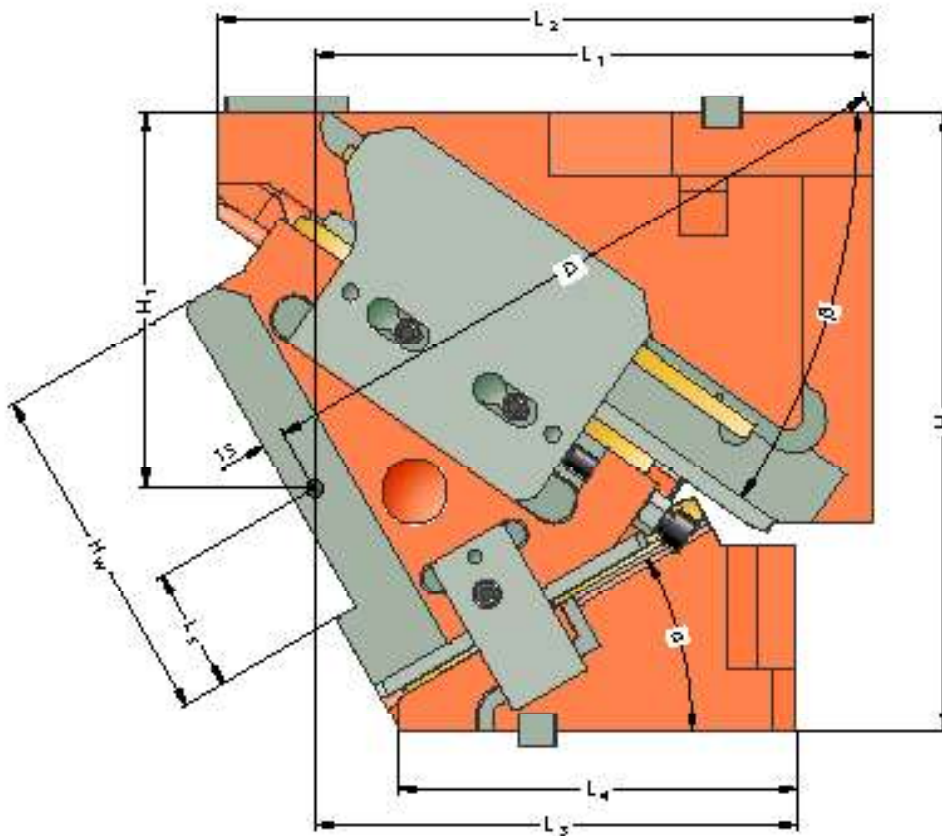
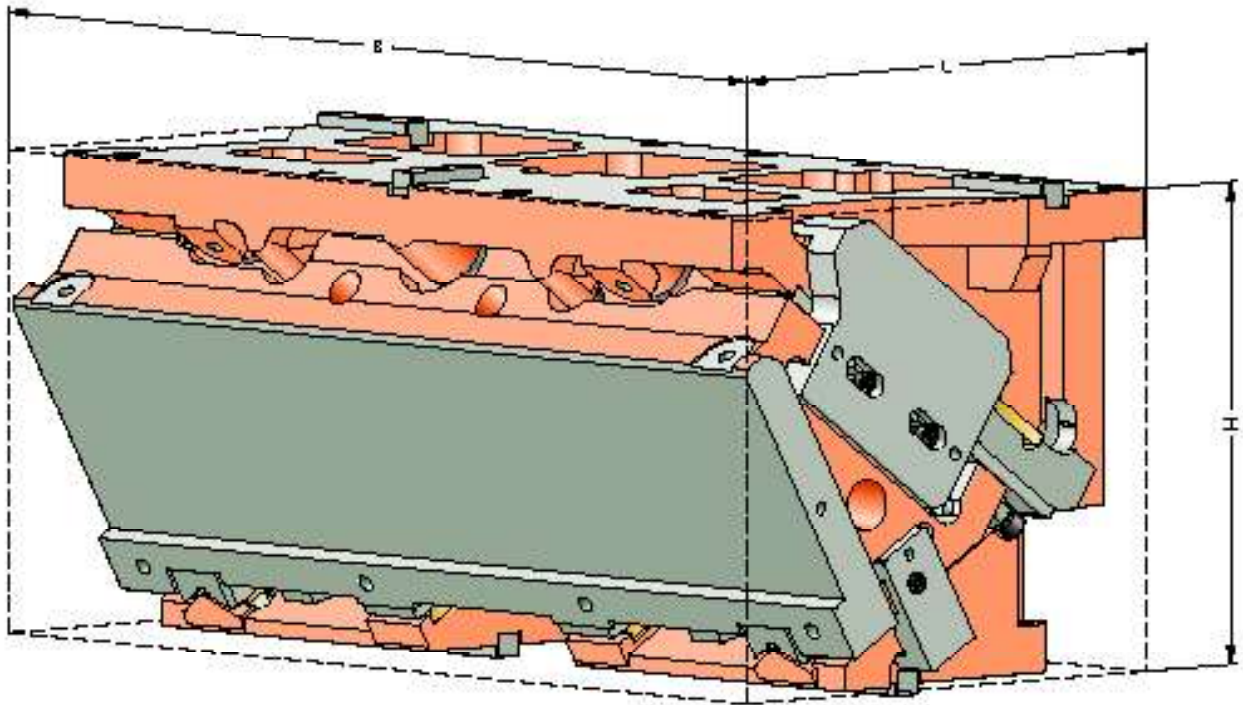

AERIAL FCC

2016.25.090./095.

SIZE TABLE

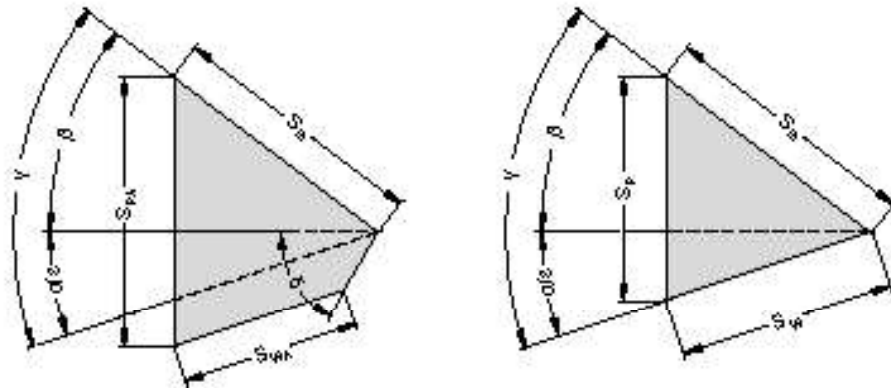

Order No.	L**	B***	H	H ₁	H _W	L ₁	L ₂	L ₃	L ₄	L ₅	D**	α	β	δ	S _W *	S _{WA} *	S _S	S _p *	S _{PA} *
2016.25.09□.	[mm]	[mm]	[mm]	[mm]	[mm]	[mm]	[mm]	[mm]	[mm]	[mm]	[mm]	[°]	[°]	[°]	[mm]	[mm]	[mm]	[mm]	[mm]
00.□000.02	395	9□0	400	208	220	365	370	280	305	80	395	0	50	45	-	45.7	100	-	95.2
05.□000.02	409.1	9□0	400	209	220	367.03	385	297.03	308	80	413.84	5	45	50	-	53.8	100	-	95.8
10.□000.02	428	9□0	400	208.61	220	374.12	385	304.12	302	80	434.66	10	45	45	-	56.6	100	-	95.5
15.□000.02	441.4	9□0	400	218.84	220	376.22	405	316.22	300	80	450.04	15	40	50	-	65.5	100	-	97.2
20.□000.02	449.3	9□0	400	229.69	220	373.27	410	298.27	270	80	459.32	20	40	45	-	68.8	100	-	99.8
25.□000.02	456.6	9□0	400	236.16	220	370.22	420	305.22	263	80	465.33	25	35	50	-	74.3	95	-	98.4
30.□000.02	458	9□0	400	243.22	220	362.01	425	312.01	258	80	465.12	30	35	45	-	79.5	95	-	103.2
35.□000.02	458.5	9□0	400	250.86	220	353.6	440	318.6	253	80	463.54	35	30	50	-	81.4	85	-	97.5
40.□000.02	462.9	9□0	400	259.08	220	349.93	450	324.93	247	80	464.59	40	25	55	-	93.0	85	-	104.0
45.□000.02	461.2	9□0	400	262.83	220	340.96	455	330.96	243	80	456.94	45	20	60	-	100.2	80	-	105.7
50.□000.02	483.2	9□0	400	267.09	220	356.64	480	336.64	264	80	463.85	50	10	-	107.2	-	70	94.3	-
55.□000.02	475.1	9□0	400	271.83	220	331.93	460	341.93	260	80	443.05	55	10	-	103.0	-	60	94.8	-
60.□000.02	480	9□0	400	277.01	220	316.78	470	326.78	237	80	428.29	60	10	-	108.3	-	55	103.4	-
65.□000.02	490	9□0	400	282.6	220	281.17	440	331.17	234	80	404.94	65	0	-	106.5	-	45	96.5	-
70.□000.02	505	9□0	400	288.54	220	265.05	435	335.05	232	80	391.79	70	0	-	117.0	-	40	109.9	-
75.□000.02	515	9□0	400	294.81	220	248.39	425	338.39	230	80	379.05	75	0	-	115.9	-	30	112.0	-

* Values rounded

** Values L, D measured for option with shouldered working surface

*** 9□0 = 900 or 950 mm

Mounting cam base:

Hexagon socket head cap screws DIN EN ISO 4762

8x M20 / Strength class min. 8.8

Dowel pins DIN EN ISO 8735

2x ø16

Mounting cam driver:

Hexagon socket head cap screws DIN EN ISO 4762

2x4 M16 / Strength class min. 8.8

Dowel pins DIN EN ISO 8735

2x2 ø12

AERIAL FCC
2016.25.090./095.
 EXPLODED VIEW

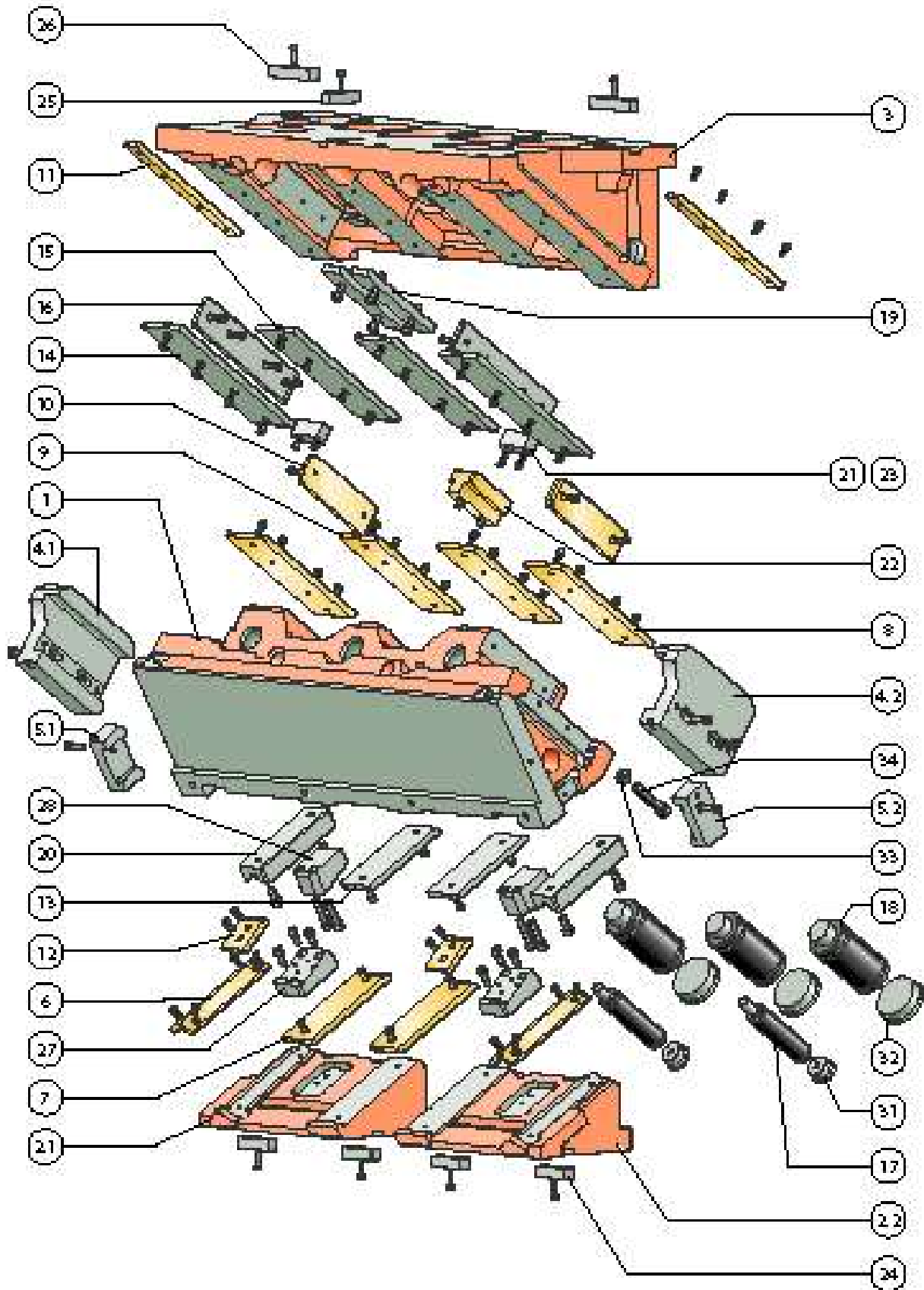

AERIAL FCC

2016.25.090./095.

PARTS LIST

Position	Piece	Designation	Material	spare part
1	1	Slider		
2.1	1	Driver, left		
2.2	1	Driver, right		
3	1	Slider cam base		
4.1	1	Clamp, left		x
4.2	1	Clamp, right		x
5.1	1	Positive return, left		x
5.2	1	Positive return, right		x
6	4	Sliding plate VDI	Bronze with solid lubricant	x
7	2	Sliding plate VDI	Bronze with solid lubricant	x
8	2	Sliding plate VDI	Bronze with solid lubricant	x
9	2	Sliding plate VDI	Bronze with solid lubricant	x
10	2	Sliding plate VDI	Bronze with solid lubricant	x
11	2	Sliding plate VDI	Bronze with solid lubricant	x
12**	2	Sliding plate VDI	Bronze with solid lubricant	x
13	2	Sliding plate VDI	Steel	x
14	2	Sliding plate VDI	Steel	x
15	2	Sliding plate VDI	Steel	x
16	2	Sliding plate VDI	Steel	x
17	2	Gas spring	2487.12.00500.125	x
18	3	Gas spring	2487.12.02400.□□□	x
19	2	Cover strip		x
20	2	Prismatic guide		x
21	2	Stop plate		x
22	1	Centre guide		x
23	2	Damper		x
24	4	Feather key (T-nut)		x
25	1	Feather key (T-nut)		x
26	2	Feather key (T-nut)		x
27**	2	Construction piece		x
28**	2	Slide pad		x
29* (not shown)	2	Curve wedge		x
30* (not shown)	2	Roller block		x
31	2	Locking screw		x
32	3	Locking screw		x
33	2	Ball-head screw		x
34	2	Hexagon nut		x

up to and including 45° with pre-acceleration

Optionally:

* Roll pre-acceleration (.1000. / .2000.)

** Plate pre-acceleration (.3000. / .4000.)

For inquiries or when ordering spare parts (x), we require the following data:

- Cam unit order no.
- Cam unit serial number
- Item number / Designation / Spare part

AERIAL FCC

2016.25.090./095.

SYSTEM AND SURROUNDING FORCES

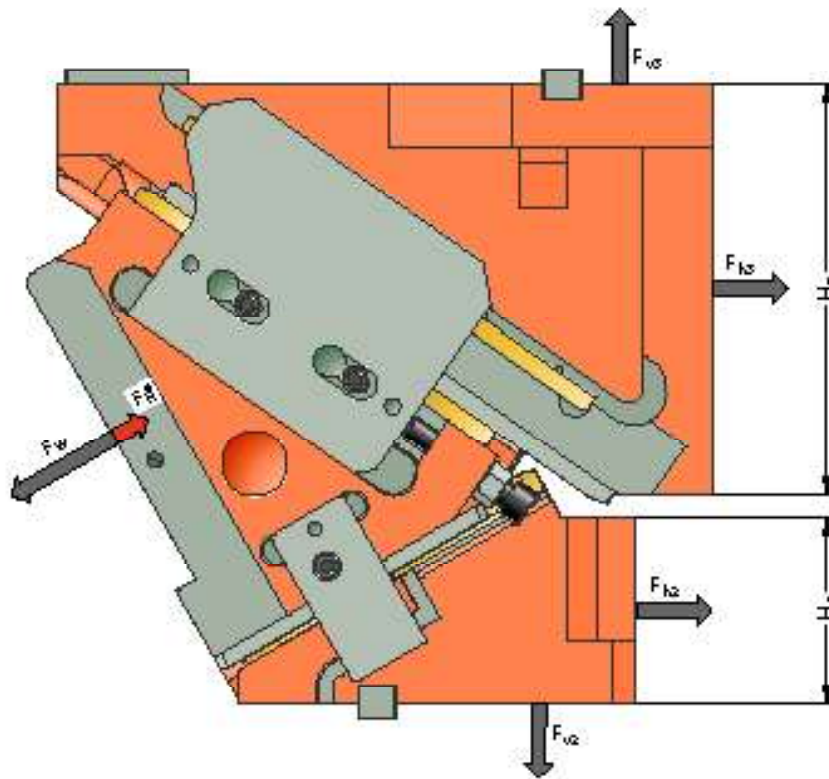

Order number	α [°]	F_W [kN]	F_{R^*} [kN]	F_{h2} [kN]	F_{v2} [kN]	F_{h3} [kN]	F_{v3} [kN]	H_2 [mm]	H_3 [mm]
2016.25.09□.00.□000.02	0	1800	149.3	0	1510	1800	1510	40	300
2016.25.09□.05.□000.02	5	1800	152.3	132	1505	1662	1662	40	275
2016.25.09□.10.□000.02	10	1800	169.6	219	1241	1554	1554	75	275
2016.25.09□.15.□000.02	15	1800	172.3	326	1217	1412	1683	80	255
2016.25.09□.20.□000.02	20	1800	195.1	431	1184	1260	1800	90	245
2016.25.09□.25.□000.02	25	1800	193.9	439	942	1192	1703	110	215
2016.25.09□.30.□000.02	30	1800	225.1	420	727	1139	1627	120	210
2016.25.09□.35.□000.02	35	1800	219.4	481	688	993	1720	140	210
2016.25.09□.40.□000.02	40	1800	221.1	540	643	839	1800	150	190
2016.25.09□.45.□000.02	45	1800	218.6	594	594	679	1866	170	170
2016.25.09□.50.□000.02	50	1800	186.1	796	668	361	2047	170	120
2016.25.09□.55.□000.02	55	1800	206.6	688	481	345	1956	180	115
2016.25.09□.60.□000.02	60	1800	256.5	567	328	333	1886	180	110
2016.25.09□.65.□000.02	65	1800	204.3	761	355	0	1986	190	85
2016.25.09□.70.□000.02	70	1800	246.0	616	224	0	1916	205	85
2016.25.09□.75.□000.02	75	1800	289.9	466	125	0	1863	220	85

* Retraction force values correspond to the spring-generated retraction force at the working point point

The forces F_{h2} , F_{v2} as well as F_{h3} , F_{v3} act on the tool environment at maximum working force F_W .

AERIAL FCC

2016.25.090./095.

FORCE DIAGRAM

shouldered

		Width 900 mm							
		135	135	135	90	135	135	135	
Height 225 mm	0°	45	87	141	434	1023	434	141	87
	45	109	183	610	1486	610	183	109	
	45	126	209	788	1813	788	209	126	
	45	126	190	707	1667	707	190	126	
	45	126	171	524	1320	524	171	126	

Support with feather key

		Width 900 mm							
		135	135	135	90	135	135	135	
Height 225 mm	0°	45	69	84	130	205	130	84	69
	45	88	110	183	297	183	110	88	
	45	101	126	236	363	236	126	101	
	45	101	114	212	333	212	114	101	
	45	101	103	157	264	157	103	101	

shouldered

		Width 900 mm							
		135	135	135	90	135	135	135	
Height 225 mm	5°	45	87	143	441	1057	441	143	87
	45	110	186	618	1498	618	186	110	
	45	127	214	795	1823	795	214	127	
	45	128	194	714	1678	714	194	128	
	45	129	174	536	1339	536	174	129	

Support with feather key

		Width 900 mm							
		135	135	135	90	135	135	135	
Height 225 mm	5°	45	70	86	145	254	145	86	70
	45	88	112	204	360	204	112	88	
	45	102	128	262	437	262	128	102	
	45	102	116	236	403	236	116	102	
	45	103	104	177	321	177	104	103	

shouldered

		Width 900 mm							
		135	135	135	90	135	135	135	
Height 225 mm	10°	45	87	144	443	1080	443	144	87
	45	110	188	620	1496	620	188	110	
	45	127	216	795	1815	795	216	127	
	45	128	196	715	1673	715	196	128	
	45	130	175	542	1346	542	175	130	

Support with feather key

		Width 900 mm							
		135	135	135	90	135	135	135	
Height 225 mm	10°	45	70	86	160	302	160	86	70
	45	88	113	223	419	223	113	88	
	45	102	130	286	508	286	130	102	
	45	103	117	257	468	257	117	103	
	45	104	105	195	377	195	105	104	

shouldered

		Width 900 mm							
		135	135	135	90	135	135	135	
Height 225 mm	15°	45	88	146	450	1113	450	146	88
	45	111	192	627	1508	627	192	111	
	45	128	221	802	1825	802	221	128	
	45	130	199	722	1684	722	199	130	
	45	132	178	553	1365	553	178	132	

Support with feather key

		Width 900 mm							
		135	135	135	90	135	135	135	
Height 225 mm	15°	45	70	88	175	356	175	88	70
	45	89	115	245	482	245	115	89	
	45	103	133	313	584	313	133	103	
	45	104	120	282	539	282	120	104	
	45	106	107	216	437	216	107	106	

shouldered

		Width 900 mm							
		135	135	135	90	135	135	135	
Height 225 mm	20°	45	88	147	452	1136	452	147	88
	45	110	194	629	1505	629	194	110	
	45	128	223	802	1817	802	223	128	
	45	131	201	723	1679	723	201	131	
	45	133	179	559	1371	559	179	133	

Support with feather key

		Width 900 mm							
		135	135	135	90	135	135	135	
Height 225 mm	20°	45	70	88	190	409	190	88	70
	45	88	116	264	542	264	116	88	
	45	102	134	337	654	337	134	102	
	45	105	121	304	604	304	121	105	
	45	107	107	235	494	235	107	107	

shouldered

		Width 900 mm							
		135	135	135	90	135	135	135	
Height 225 mm	25°	45	87	148	454	1157	454	148	87
	45	110	196	630	1502	630	196	110	
	45	128	225	801	1809	801	225	128	
	45	131	203	723	1673	723	203	131	
	45	135	180	565	1377	565	180	135	

Support with feather key

		Width 900 mm							
		135	135	135	90	135	135	135	
Height 225 mm	25°	45	70	89	204	463	204	89	70
	45	88	117	284	601	284	117	88	
	45	102	135	360	724	360	135	102	
	45	105	122	325	669	325	122	105	
	45	108	108	254	551	254	108	108	

AERIAL FCC

2016.25.090./095.

FORCE DIAGRAM

shouldered

		Width 900 mm							
		135	135	135	90	135	135	135	
Height 225 mm	30°	45	88	151	461	1190	461	151	88
	45	111	199	638	1514	638	199	111	
	45	129	230	808	1819	808	230	129	
	45	133	206	730	1684	730	206	133	
	45	137	183	576	1396	576	183	137	

Support with feather key

		Width 900 mm							
		135	135	135	90	135	135	135	
Height 225 mm	30°	45	70	93	221	524	221	93	70
	45	89	124	306	666	306	124	89	
	45	103	143	388	800	388	143	103	
	45	106	128	351	741	351	128	106	
	45	110	113	277	614	277	113	110	

		Width 900 mm							
		135	135	135	90	135	135	135	
Height 225 mm	35°	45	88	151	463	1210	463	151	88
	45	110	201	639	1510	639	201	110	
	45	129	232	807	1810	807	232	129	
	45	133	208	730	1678	730	208	133	
	45	138	184	582	1401	582	184	138	

		Width 900 mm							
		135	135	135	90	135	135	135	
Height 225 mm	35°	45	70	97	236	581	236	97	70
	45	88	129	326	725	326	129	88	
	45	103	148	411	869	411	148	103	
	45	107	133	372	805	372	133	107	
	45	110	118	297	672	297	118	110	

		Width 900 mm							
		135	135	135	90	135	135	135	
Height 225 mm	40°	45	91	152	480	1244	480	152	91
	45	115	202	655	1539	655	202	115	
	45	134	233	807	1808	807	233	134	
	45	134	207	722	1661	722	207	134	
	45	135	180	574	1389	574	180	135	

		Width 900 mm							
		135	135	135	90	135	135	135	
Height 225 mm	40°	45	72	100	259	647	259	100	72
	45	92	133	354	800	354	133	92	
	45	107	154	436	940	436	154	107	
	45	107	136	390	864	390	136	107	
	45	108	119	310	722	310	119	108	

		Width 900 mm							
		135	135	135	90	135	135	135	
Height 225 mm	45°	45	93	153	498	1278	498	153	93
	45	120	203	671	1568	671	203	120	
	45	138	234	807	1806	807	234	138	
	45	135	205	713	1645	713	205	135	
	45	132	177	566	1377	566	177	132	

		Width 900 mm							
		135	135	135	90	135	135	135	
Height 225 mm	45°	45	75	104	284	716	284	104	75
	45	96	138	382	878	382	138	96	
	45	111	159	460	1011	460	159	111	
	45	108	140	407	921	407	140	108	
	45	106	120	322	771	322	120	106	

		Width 900 mm							
		135	135	135	90	135	135	135	
Height 225 mm	50°	45	97	155	521	1325	521	155	97
	45	125	206	693	1613	693	206	125	
	45	145	237	815	1821	815	237	145	
	45	138	206	712	1645	712	206	138	
	45	130	175	563	1378	563	175	130	

		Width 900 mm							
		135	135	135	90	135	135	135	
Height 225 mm	50°	45	78	108	313	795	313	108	78
	45	100	144	416	968	416	144	100	
	45	116	166	489	1093	489	166	116	
	45	110	144	427	987	427	144	110	
	45	104	122	338	827	338	122	104	

		Width 900 mm							
		135	135	135	90	135	135	135	
Height 225 mm	55°	45	100	155	539	1360	539	155	100
	45	130	207	709	1642	709	207	130	
	45	150	238	815	1819	815	238	150	
	45	139	204	703	1629	703	204	139	
	45	127	171	555	1366	555	171	127	

		Width 900 mm							
		135	135	135	90	135	135	135	
Height 225 mm	55°	45	80	112	340	870	340	112	80
	45	104	149	447	1051	447	149	104	
	45	120	171	513	1164	513	171	120	
	45	111	147	443	1042	443	147	111	
	45	102	123	349	874	349	123	102	

AERIAL FCC

2016.25.090./095.

FORCE DIAGRAM

shouldered

		Width 900 mm							
		135	135	135	90	135	135	135	
Height 225 mm	60°	45	103	156	557	1394	557	156	103
	45	134	208	725	1672	725	208	134	
	45	155	238	815	1816	815	238	155	
	45	140	203	694	1613	694	203	140	
	45	125	168	546	1354	546	168	125	

Support with feather key

		Width 900 mm							
		135	135	135	90	135	135	135	
Height 225 mm	60°	45	82	115	368	948	368	115	82
	45	108	154	479	1137	479	154	108	
	45	124	176	538	1235	538	176	124	
	45	112	150	458	1097	458	150	112	
	45	100	124	361	921	361	124	100	

shouldered

		Width 900 mm							
		135	135	135	90	135	135	135	
Height 225 mm	65°	45	105	157	575	1428	575	157	105
	45	139	209	741	1701	741	209	139	
	45	160	239	815	1814	815	239	160	
	45	141	202	686	1596	686	202	141	
	45	122	164	538	1342	538	164	122	

Support with feather key

		Width 900 mm							
		135	135	135	90	135	135	135	
Height 225 mm	65°	45	84	119	397	1028	397	119	84
	45	111	159	511	1225	511	159	111	
	45	128	182	562	1306	562	182	128	
	45	112	153	473	1149	473	153	112	
	45	97	125	371	966	371	125	97	

shouldered

		Width 900 mm							
		135	135	135	90	135	135	135	
Height 225 mm	70°	45	108	157	593	1462	593	157	108
	45	144	210	757	1730	757	210	144	
	45	164	240	815	1811	815	240	164	
	45	142	200	677	1580	677	200	142	
	45	119	160	530	1330	530	160	119	

Support with feather key

		Width 900 mm							
		135	135	135	90	135	135	135	
Height 225 mm	70°	45	87	123	427	1111	427	123	87
	45	115	164	545	1315	545	164	115	
	45	132	187	587	1377	587	187	132	
	45	113	156	488	1201	488	156	113	
	45	95	125	382	1011	382	125	95	

shouldered

		Width 900 mm							
		135	135	135	90	135	135	135	
Height 225 mm	75°	45	111	158	611	1497	611	158	111
	45	148	211	773	1759	773	211	148	
	45	169	241	815	1809	815	241	169	
	45	143	199	669	1563	669	199	143	
	45	116	157	522	1318	522	157	116	

Support with feather key

		Width 900 mm							
		135	135	135	90	135	135	135	
Height 225 mm	75°	45	89	126	458	1197	458	126	89
	45	119	169	580	1407	580	169	119	
	45	136	193	612	1447	612	193	136	
	45	114	159	501	1251	501	159	114	
	45	93	125	391	1054	391	125	93	



AERIAL FCC 2016.25.100./105.

Working width: 1000/1050 mm
Performance class: 2000 kN

AERIAL FCC
2016.25.100./105.
SIZE TABLE

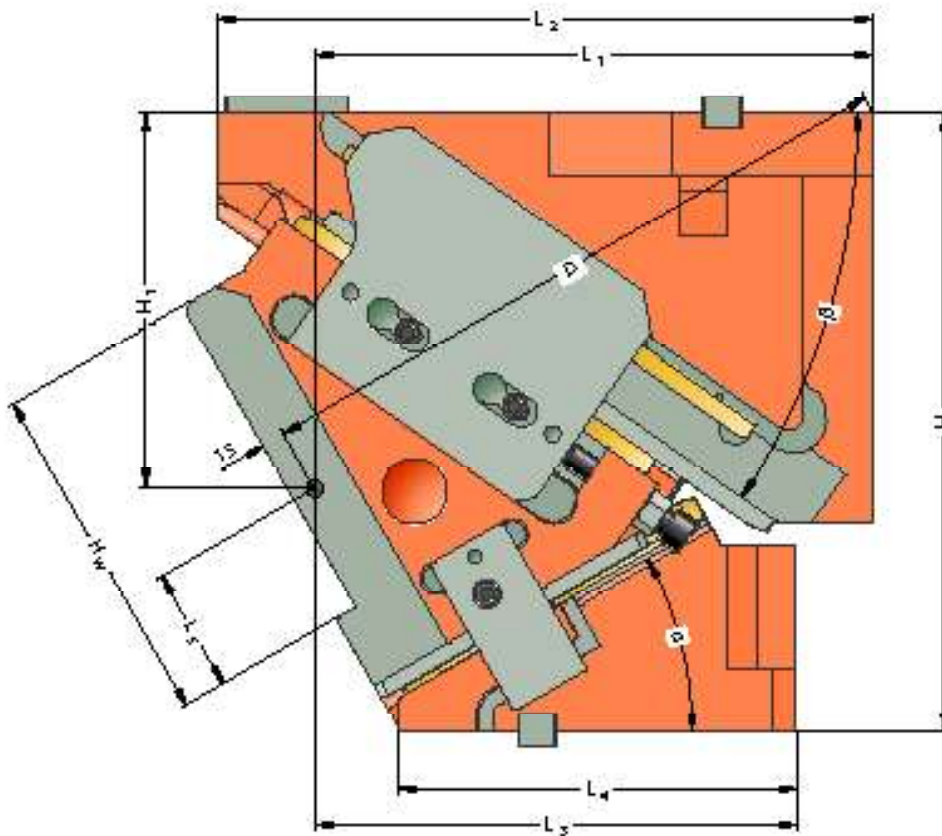
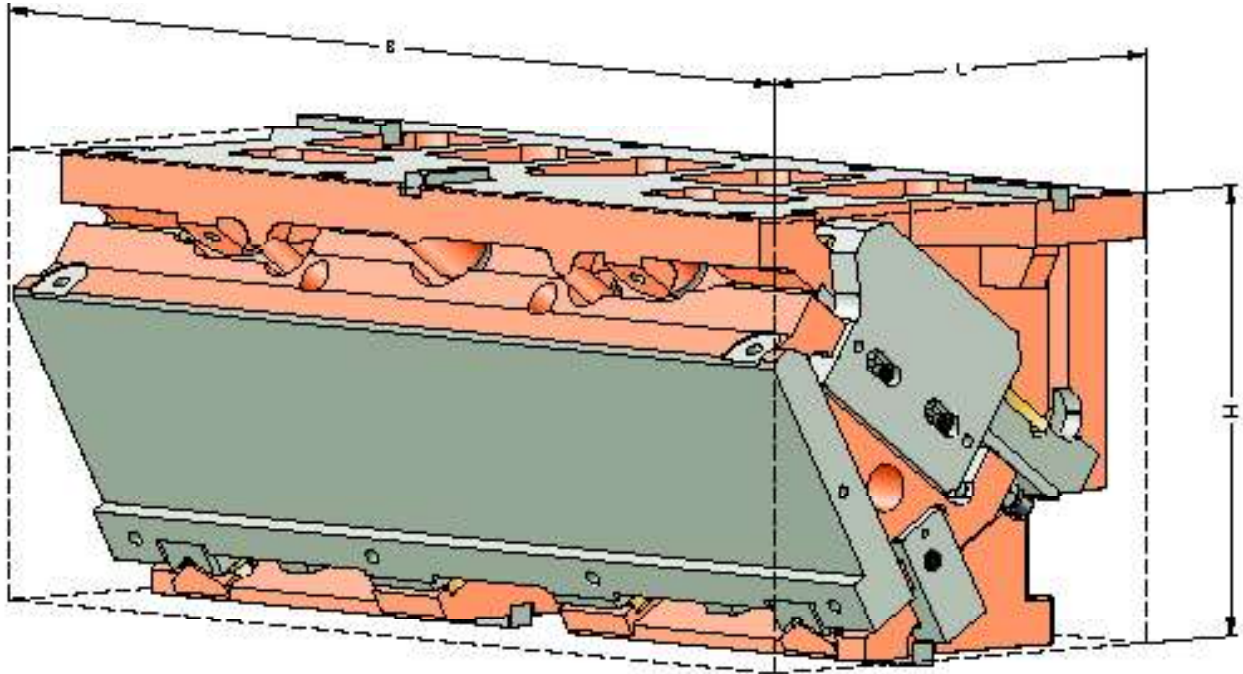

AERIAL FCC

2016.25.100./105.

SIZE TABLE

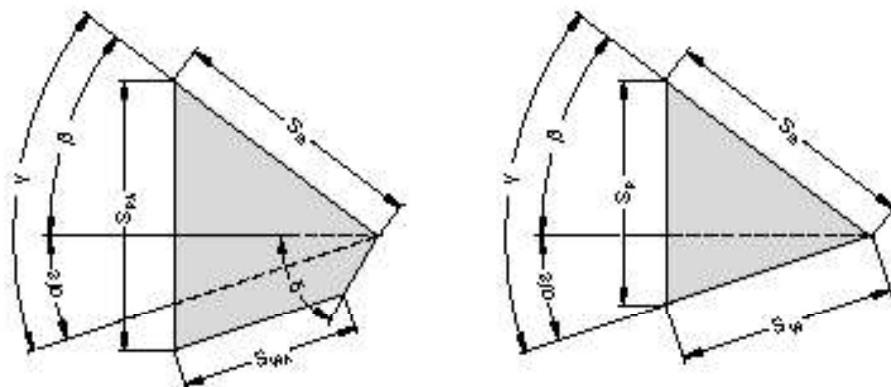

Order No.	L**	B***	H	H ₁	H _W	L ₁	L ₂	L ₃	L ₄	L ₅	D**	α	β	δ	S _W *	S _{WA} *	S _S	S _P *	S _{PA} *
2016.25.10□.	[mm]	[mm]	[mm]	[mm]	[mm]	[mm]	[mm]	[mm]	[mm]	[mm]	[mm]	[°]	[°]	[°]	[mm]	[mm]	[mm]	[mm]	[mm]
00.□000.02	395	10□0	400	208	220	365	370	280	305	80	395	0	50	45	-	45.7	100	-	95.2
05.□000.02	409.1	10□0	400	209	220	367.03	385	297.03	308	80	413.8	5	45	50	-	53.8	100	-	95.8
10.□000.02	428	10□0	400	208.61	220	374.12	385	304.12	302	80	434.7	10	45	45	-	56.6	100	-	95.5
15.□000.02	441.4	10□0	400	218.84	220	376.22	405	316.22	300	80	450	15	40	50	-	65.5	100	-	97.2
20.□000.02	449.3	10□0	400	229.69	220	373.27	410	298.27	270	80	459.3	20	40	45	-	68.8	100	-	99.8
25.□000.02	456.6	10□0	400	236.16	220	370.22	420	305.22	263	80	465.3	25	35	50	-	74.3	95	-	98.4
30.□000.02	458	10□0	400	243.22	220	362.01	425	312.01	258	80	465.1	30	35	45	-	79.5	95	-	103.2
35.□000.02	458.5	10□0	400	250.86	220	353.6	440	318.6	253	80	463.5	35	30	50	-	81.4	85	-	97.5
40.□000.02	462.9	10□0	400	259.08	220	349.93	450	324.93	247	80	464.6	40	25	55	-	93.0	85	-	104.0
45.□000.02	461.2	10□0	400	262.83	220	340.96	455	330.96	243	80	456.9	45	20	60	-	100.2	80	-	105.7
50.□000.02	483.2	10□0	400	267.09	220	356.64	480	336.64	264	80	463.9	50	10	-	107.2	-	70	94.3	-
55.□000.02	475.1	10□0	400	271.83	220	331.93	460	341.93	260	80	443.1	55	10	-	103.0	-	60	94.8	-
60.□000.02	480	10□0	400	277.01	220	316.78	470	326.78	237	80	428.3	60	10	-	108.3	-	55	103.4	-
65.□000.02	490	10□0	400	282.6	220	281.17	440	331.17	234	80	404.9	65	0	-	106.5	-	45	96.5	-
70.□000.02	505	10□0	400	288.54	220	265.05	435	335.05	232	80	391.8	70	0	-	117.0	-	40	109.9	-
75.□000.02	515	10□0	400	294.81	220	248.39	425	338.39	230	80	379.1	75	0	-	115.9	-	30	112.0	-

* Values rounded

** Values L, D measured for option with shouldered working surface

*** 10□0 = 1000 or 1050 mm

Mounting cam base:

Hexagon socket head cap screws DIN EN ISO 4762

8x M20 / Strength class min. 8.8

Dowel pins DIN EN ISO 8735

2x ø16

Mounting cam driver:

Hexagon socket head cap screws DIN EN ISO 4762

2x4 M16 / Strength class min. 8.8

Dowel pins DIN EN ISO 8735

2x2 ø12

AERIAL FCC
2016.25.100./105.
 EXPLODED VIEW

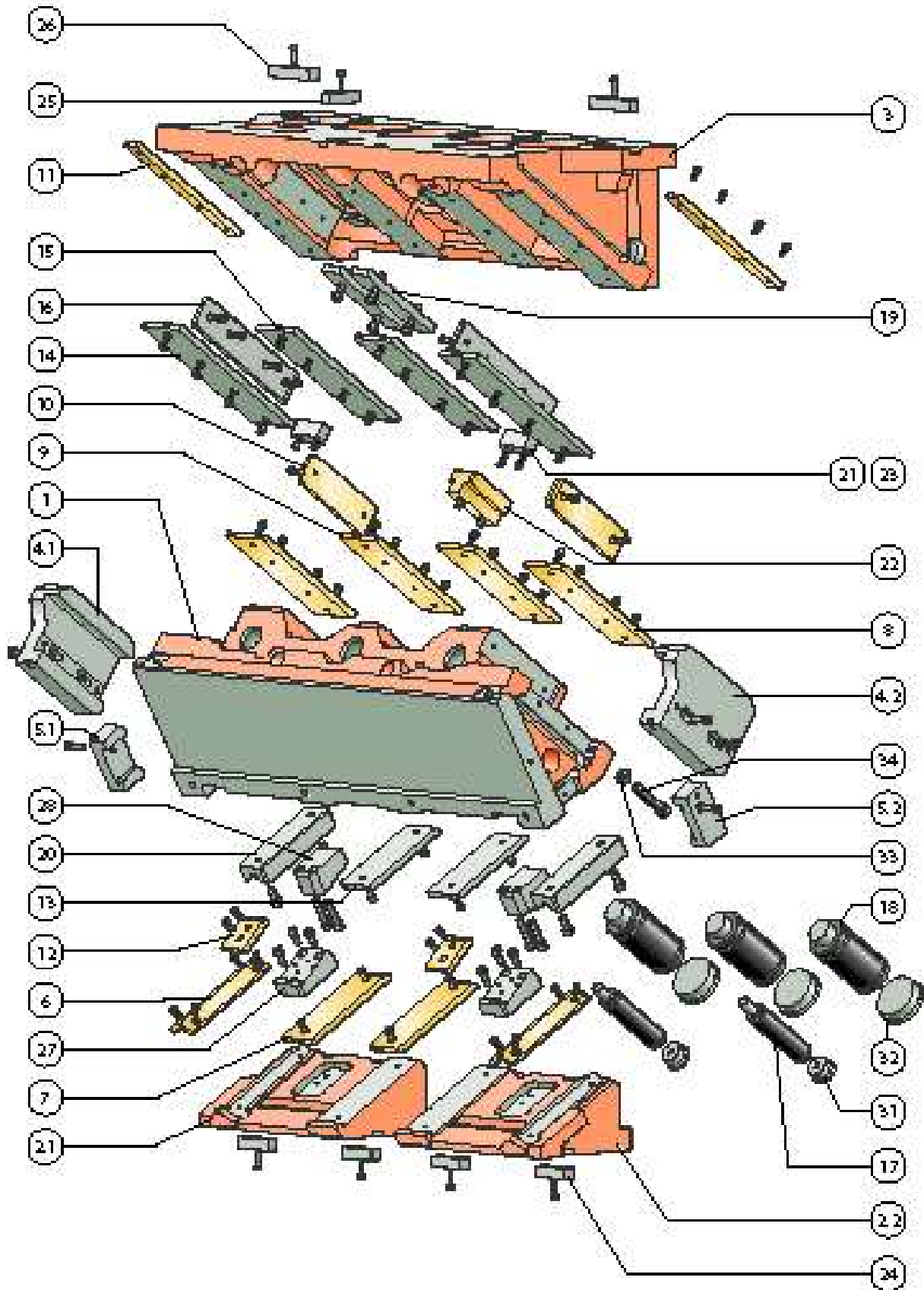

AERIAL FCC

2016.25.100./105.

PARTS LIST

Position	Piece	Designation	Material	spare part
1	1	Slider		
2.1	1	Driver, left		
2.2	1	Driver, right		
3	1	Slider cam base		
4.1	1	Clamp, left		x
4.2	1	Clamp, right		x
5.1	1	Positive return, left		x
5.2	1	Positive return, right		x
6	4	Sliding plate VDI	Bronze with solid lubricant	x
7	2	Sliding plate VDI	Bronze with solid lubricant	x
8	2	Sliding plate VDI	Bronze with solid lubricant	x
9	2	Sliding plate VDI	Bronze with solid lubricant	x
10	2	Sliding plate VDI	Bronze with solid lubricant	x
11	2	Sliding plate VDI	Bronze with solid lubricant	x
12**	2	Sliding plate VDI	Bronze with solid lubricant	x
13	2	Sliding plate VDI	Steel	x
14	2	Sliding plate VDI	Steel	x
15	2	Sliding plate VDI	Steel	x
16	2	Sliding plate VDI	Steel	x
17	2	Gas spring	2487.12.00500.125	x
18	3	Gas spring	2487.12.02400.□□□	x
19	2	Cover strip		x
20	2	Prismatic guide		x
21	2	Stop plate		x
22	1	Centre guide		x
23	2	Damper		x
24	4	Feather key (T-nut)		x
25	1	Feather key (T-nut)		x
26	2	Feather key (T-nut)		x
27**	2	Construction piece		x
28**	2	Slide pad		x
29* (not shown)	2	Curve wedge		x
30* (not shown)	2	Roller block		x
31	2	Locking screw		x
32	3	Locking screw		x
33	2	Ball-head screw		x
34	2	Hexagon nut		x

up to and including 45° with pre-acceleration

Optionally:

* Roll pre-acceleration (.1000. / .2000.)

** Plate pre-acceleration (.3000. / .4000.)

For inquiries or when ordering spare parts (x), we require the following data:

- Cam unit order no.
- Cam unit serial number
- Item number / Designation / Spare part

AERIAL FCC

2016.25.100./105.

SYSTEM AND SURROUNDING FORCES

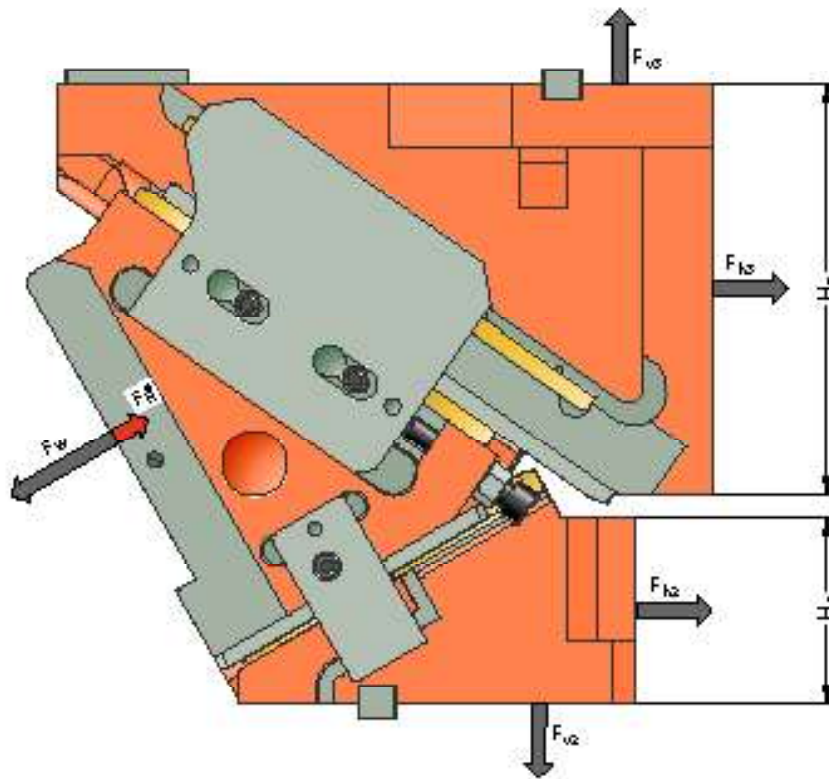

Order number	α [°]	F_W [kN]	F_R^* [kN]	F_{h2} [kN]	F_{v2} [kN]	F_{h3} [kN]	F_{v3} [kN]	H_2 [mm]	H_3 [mm]
2016.25.10□.00.□000.02	0	2000	149.3	0	1678	2000	1678	40	300
2016.25.10□.05.□000.02	5	2000	152.3	146	1672	1846	1846	40	275
2016.25.10□.10.□000.02	10	2000	169.6	243	1379	1726	1726	75	275
2016.25.10□.15.□000.02	15	2000	172.3	362	1353	1569	1870	80	255
2016.25.10□.20.□000.02	20	2000	195.1	479	1316	1400	2000	90	245
2016.25.10□.25.□000.02	25	2000	193.9	488	1047	1325	1892	110	215
2016.25.10□.30.□000.02	30	2000	225.1	466	808	1266	1808	120	210
2016.25.10□.35.□000.02	35	2000	219.4	535	764	1103	1911	140	210
2016.25.10□.40.□000.02	40	2000	221.1	599	714	933	2000	150	190
2016.25.10□.45.□000.02	45	2000	218.6	659	659	755	2074	170	170
2016.25.10□.50.□000.02	50	2000	186.1	885	742	401	2274	170	120
2016.25.10□.55.□000.02	55	2000	206.6	764	535	383	2173	180	115
2016.25.10□.60.□000.02	60	2000	256.5	630	364	370	2096	180	110
2016.25.10□.65.□000.02	65	2000	204.3	845	394	0	2207	190	85
2016.25.10□.70.□000.02	70	2000	246.0	684	249	0	2128	205	85
2016.25.10□.75.□000.02	75	2000	289.9	518	139	0	2071	220	85

* Retraction force values correspond to the spring-generated retraction force at the working point point

The forces F_{h2} , F_{v2} as well as F_{h3} , F_{v3} act on the tool environment at maximum working force F_W .

AERIAL FCC

2016.25.100./105.

FORCE DIAGRAM

shouldered

		Width 1000 mm						
		150	150	150	100	150	150	150
Height 225 mm	45	101	174	549	1217	549	174	101
	45	129	227	751	1722	751	227	129
	45	149	257	919	2021	919	257	149
	45	144	219	743	1707	743	219	144
	45	138	180	567	1393	567	180	138

Support with feather key

		Width 1000 mm						
		150	150	150	100	150	150	150
Height 225 mm	45	81	104	165	243	165	104	81
	45	103	136	225	344	225	136	103
	45	119	154	276	404	276	154	119
	45	115	131	223	341	223	131	115
	45	111	108	170	279	170	108	111

5°

		Width 1000 mm						
		150	150	150	100	150	150	150
Height 225 mm	45	100	174	543	1230	543	174	100
	45	128	227	747	1713	747	227	128
	45	148	258	918	2020	918	258	148
	45	144	221	755	1730	755	221	144
	45	140	184	581	1416	581	184	140

5°

		Width 1000 mm						
		150	150	150	100	150	150	150
Height 225 mm	45	80	104	179	295	179	104	80
	45	102	136	246	411	246	136	102
	45	118	155	303	485	303	155	118
	45	115	133	249	415	249	133	115
	45	112	110	192	340	192	110	112

10°

		Width 1000 mm						
		150	150	150	100	150	150	150
Height 225 mm	45	99	173	538	1242	538	173	99
	45	126	228	742	1703	742	228	126
	45	146	259	917	2019	917	259	146
	45	144	223	768	1753	768	223	144
	45	142	187	595	1439	595	187	142

10°

		Width 1000 mm						
		150	150	150	100	150	150	150
Height 225 mm	45	79	104	194	348	194	104	79
	45	101	137	267	477	267	137	101
	45	117	156	330	565	330	156	117
	45	115	134	276	491	276	134	115
	45	114	112	214	403	214	112	114

15°

		Width 1000 mm						
		150	150	150	100	150	150	150
Height 225 mm	45	97	173	532	1254	532	173	97
	45	124	228	737	1694	737	228	124
	45	145	260	917	2017	917	260	145
	45	145	226	780	1776	780	226	145
	45	144	191	608	1463	608	191	144

15°

		Width 1000 mm						
		150	150	150	100	150	150	150
Height 225 mm	45	78	104	208	401	208	104	78
	45	100	137	287	542	287	137	100
	45	116	156	358	645	358	156	116
	45	116	135	304	568	304	135	116
	45	115	115	237	468	237	115	115

20°

		Width 1000 mm						
		150	150	150	100	150	150	150
Height 225 mm	45	96	173	527	1267	527	173	96
	45	123	228	732	1685	732	228	123
	45	143	261	916	2016	916	261	143
	45	145	228	793	1798	793	228	145
	45	146	195	622	1486	622	195	146

20°

		Width 1000 mm						
		150	150	150	100	150	150	150
Height 225 mm	45	77	104	221	456	221	104	77
	45	98	137	308	607	308	137	98
	45	115	157	385	726	385	157	115
	45	116	137	333	647	333	137	116
	45	117	117	261	535	261	117	117

25°

		Width 1000 mm						
		150	150	150	100	150	150	150
Height 225 mm	45	95	173	522	1279	522	173	95
	45	121	228	728	1676	728	228	121
	45	142	262	916	2014	916	262	142
	45	145	230	805	1821	805	230	145
	45	148	198	635	1509	635	198	148

25°

		Width 1000 mm						
		150	150	150	100	150	150	150
Height 225 mm	45	76	104	235	512	235	104	76
	45	97	137	327	670	327	137	97
	45	114	157	412	806	412	157	114
	45	116	138	362	728	362	138	116
	45	119	119	286	604	286	119	119

AERIAL FCC

2016.25.100./105.

FORCE DIAGRAM

shouldered

		Width 1000 mm							
		150	150	150	100	150	150	150	
Height 225 mm	30°	45	94	173	516	1291	516	173	94
	45	120	229	723	1667	723	229	120	
	45	140	263	915	2013	915	263	140	
	45	145	232	818	1844	818	232	145	
	45	150	202	649	1533	649	202	150	

Support with feather key

		Width 1000 mm							
		150	150	150	100	150	150	150	
Height 225 mm	30°	45	75	107	248	568	248	107	75
	45	96	142	347	733	347	142	96	
	45	112	163	439	886	439	163	112	
	45	116	144	393	811	393	144	116	
	45	120	125	312	674	312	125	120	

		Width 1000 mm							
		150	150	150	100	150	150	150	
Height 225 mm	35°	45	93	173	511	1304	511	173	93
	45	118	229	718	1658	718	229	118	
	45	139	264	915	2012	915	264	139	
	45	146	234	830	1867	830	234	146	
	45	152	205	663	1556	663	205	152	

		Width 1000 mm							
		150	150	150	100	150	150	150	
Height 225 mm	35°	45	74	111	261	626	261	111	74
	45	95	146	366	796	366	146	95	
	45	111	169	466	966	466	169	111	
	45	117	150	423	896	423	150	117	
	45	122	131	338	747	338	131	122	

		Width 1000 mm							
		150	150	150	100	150	150	150	
Height 225 mm	40°	45	96	173	535	1350	535	173	96
	45	124	231	736	1690	736	231	124	
	45	145	266	918	2014	918	266	145	
	45	147	233	823	1853	823	233	147	
	45	150	201	655	1547	655	201	150	

		Width 1000 mm							
		150	150	150	100	150	150	150	
Height 225 mm	40°	45	77	114	289	702	289	114	77
	45	99	152	397	879	397	152	99	
	45	116	175	496	1047	496	175	116	
	45	118	154	444	964	444	154	118	
	45	120	132	354	804	354	132	120	

		Width 1000 mm							
		150	150	150	100	150	150	150	
Height 225 mm	45°	45	99	173	558	1396	558	173	99
	45	129	232	754	1722	754	232	129	
	45	151	268	921	2016	921	268	151	
	45	149	232	816	1839	816	232	149	
	45	147	196	648	1537	648	196	147	

		Width 1000 mm							
		150	150	150	100	150	150	150	
Height 225 mm	45°	45	79	117	318	782	318	117	79
	45	104	158	430	965	430	158	104	
	45	121	182	525	1129	525	182	121	
	45	119	158	465	1030	465	158	119	
	45	117	133	369	861	369	133	117	

		Width 1000 mm							
		150	150	150	100	150	150	150	
Height 225 mm	50°	45	103	173	582	1442	582	173	103
	45	135	234	772	1755	772	234	135	
	45	158	270	925	2019	925	270	158	
	45	151	231	809	1825	809	231	151	
	45	144	191	641	1528	641	191	144	

		Width 1000 mm							
		150	150	150	100	150	150	150	
Height 225 mm	50°	45	82	121	349	865	349	121	82
	45	108	164	463	1053	463	164	108	
	45	126	189	555	1211	555	189	126	
	45	121	161	485	1095	485	161	121	
	45	115	134	384	917	384	134	115	

		Width 1000 mm							
		150	150	150	100	150	150	150	
Height 225 mm	55°	45	106	173	606	1488	606	173	106
	45	141	236	790	1787	790	236	141	
	45	164	272	928	2021	928	272	164	
	45	152	229	801	1811	801	229	152	
	45	141	186	633	1518	633	186	141	

		Width 1000 mm							
		150	150	150	100	150	150	150	
Height 225 mm	55°	45	85	124	382	952	382	124	85
	45	113	170	498	1144	498	170	113	
	45	131	196	585	1294	585	196	131	
	45	122	165	505	1159	505	165	122	
	45	113	134	399	972	399	134	113	

AERIAL FCC

2016.25.100./105.

FORCE DIAGRAM

shouldered

		Width 1000 mm							
		150	150	150	100	150	150	150	
Height 225 mm	60°	45	109	173	629	1534	629	173	109
	45	146	237	808	1820	808	237	146	
	45	170	274	931	2024	931	274	170	
	45	154	228	794	1797	794	228	154	
	45	138	182	626	1509	626	182	138	

Support with feather key

		Width 1000 mm							
		150	150	150	100	150	150	150	
Height 225 mm	60°	45	88	128	415	1043	415	128	88
	45	117	176	533	1237	533	176	117	
	45	136	203	615	1376	615	203	136	
	45	123	169	524	1222	524	169	123	
	45	110	134	413	1026	413	134	110	

shouldered

		Width 1000 mm							
		150	150	150	100	150	150	150	
Height 225 mm	65°	45	113	173	653	1580	653	173	113
	45	152	239	826	1852	826	239	152	
	45	176	277	935	2026	935	277	176	
	45	156	227	787	1783	787	227	156	
	45	135	177	618	1499	618	177	135	

Support with feather key

		Width 1000 mm							
		150	150	150	100	150	150	150	
Height 225 mm	65°	45	90	131	451	1138	451	131	90
	45	122	182	570	1333	570	182	122	
	45	141	210	645	1459	645	210	141	
	45	124	172	543	1284	543	172	124	
	45	108	135	427	1079	427	135	108	

shouldered

		Width 1000 mm							
		150	150	150	100	150	150	150	
Height 225 mm	70°	45	116	173	677	1627	677	173	116
	45	157	241	844	1884	844	241	157	
	45	182	279	938	2029	938	279	182	
	45	157	225	780	1770	780	225	157	
	45	132	172	611	1490	611	172	132	

Support with feather key

		Width 1000 mm							
		150	150	150	100	150	150	150	
Height 225 mm	70°	45	93	135	487	1236	487	135	93
	45	126	188	608	1432	608	188	126	
	45	146	217	675	1542	675	217	146	
	45	126	176	561	1345	561	176	126	
	45	106	134	440	1132	440	134	106	

shouldered

		Width 1000 mm							
		150	150	150	100	150	150	150	
Height 225 mm	75°	45	120	173	700	1673	700	173	120
	45	163	243	862	1917	862	243	163	
	45	188	281	941	2031	941	281	188	
	45	159	224	772	1756	772	224	159	
	45	129	168	604	1480	604	168	129	

Support with feather key

		Width 1000 mm							
		150	150	150	100	150	150	150	
Height 225 mm	75°	45	96	138	525	1338	525	138	96
	45	130	194	647	1534	647	194	130	
	45	151	225	706	1625	706	225	151	
	45	127	179	579	1405	579	179	127	
	45	103	134	453	1184	453	134	103	