

Ejector pin, hardened, round stepped, DIN ISO 8694

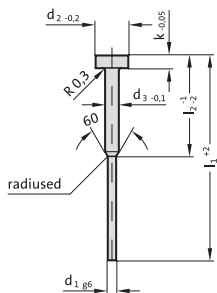

238.1.



Material:

WS
Order No 238.1.
Hardness:
Shaft 60 ± 2 HRC
Head 45 ± 5 HRC

WS = Alloy Tool Steel

Material No 1.2210, 1.2516, 1.2842 or similar.

Characteristics: Hard and tough tool steel, medium wear resistance.

Execution:

Shank hardened and precision ground.
Head hot upset-forged.

238.1. Ejector pin, hardened, round stepped, DIN ISO 8694

d ₁	d ₂	d ₃	k	l ₁	63	80	100	125	160	200
				l ₂	30	32	50	50	63	80
0.8	4	2	2		●	●	●	●	●	
0.9	4	2	2		●	●	●	●	●	
1	4	2	2		●	●	●	●	●	●
1.1	4	2	2		●	●	●	●	●	●
1.2	4	2	2		●	●	●	●	●	●
1.3	4	2	2		●	●	●	●	●	●
1.4	4	2	2		●	●	●	●	●	●
1.5	6	3	3		●	●	●	●	●	●
1.6	6	3	3		●	●	●	●	●	●
1.7	6	3	3		●	●	●	●	●	●
1.8	6	3	3		●	●	●	●	●	●
1.9	6	3	3		●	●	●	●	●	●
2	6	3	3		●	●	●	●	●	●
2.1	6	3	3		●	●	●	●	●	●
2.2	6	3	3		●	●	●	●	●	●
2.3	6	3	3		●	●	●	●	●	●
2.4	6	3	3		●	●	●	●	●	●
2.5	6	3	3		●	●	●	●	●	●

Ordering Code (example):

Ejector pin, hardened, round stepped, DIN ISO 8694	=238.1.
Diameter d ₁	0.8 mm = 0080.
Length l ₁	63 mm = 063
Order No	=238.1.0080. 063